

A-21

Chippewa NATIONAL FOREST
CORNERS OF THE PUBLIC SURVEY

T. 144 R. 28 5th Mer.

Sec. Corner common to Sections

1, and 2

Corner consists of a _____ (not) in place

State condition _____

Dimensions above ground _____ inches

Sketch grooves, letters, figures, or notches, on proper face or edge.

CARDINAL POSITION

DIAGONAL POSITION

--	--	--	--

--	--	--	--

N W S E

NW SW SE NE

Mound of _____ is located _____

Pits are located _____

Sketch markings of Bearing Trees (or Rocks) in proper box and fill blanks below, giving bearings from Corner to Trees and Distances in Links.

R 25W

B.T.

Species N. Pine Stump 5' high

Diameter 22"

Bearing _____

Distance _____

Do you believe this to be a genuine Land Office Corner? Yes

If not, why? _____

D. Kirkman & C. B. Stahl

(Signature)

1/27/28

(Date)

J. F.

(Title)

Hill of 50 seed trees N

In low popple pocket. Reprad.

Corner again

Give any further facts which will aid in finding this

40 ft. or more distant.

from which this Corner bears About SE

side of E & W line

tree 5 inches diameter, on the N

Metal Location Poster is on a Aspect

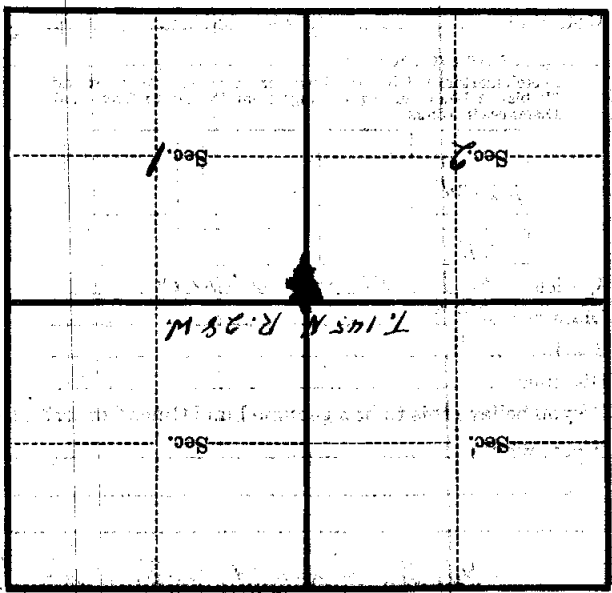

(Make sketch of topography near Corner)

T. 144 R. 28 3-4 Mer.

U. S. Department of Agriculture

FOREST SERVICE

Copy

A-21

NATIONAL FOREST

CORNERS OF THE PUBLIC SURVEY

T. ¹⁴⁵147 R. 28 Mer.

Sec. Corner common to Sections 1, 2, and

Corner consists of a (not) in place State condition

Dimensions above ground inches

Sketch grooves, letters, figures, or notches, on proper face or edge.

CARDINAL POSITION

DIAGONAL POSITION

--	--	--	--

N W S E

--	--	--	--

NW SW SE NE

Mound of is located

Pits are located

Sketch markings of Bearing Trees (or Rocks) in proper box and fill blanks below, giving bearings from Corner to Trees and Distances in Links.

R 280			
BT			

Species N. Pine 5' ht

Diameter 22

Bearing

Distance

Do you believe this to be a genuine Land Office Corner? Yes

If not, why?

D. Hartman & C. B. STAT

(Signature)

J. F.

(Title)

1-27-28

(Date)

A-21

Section of topography near Corner

Corner again.

In low poplar forest. Report

Hill at 30 sec 8 from N

Give any further facts which will aid in finding this

chains distant.

from which this Corner bears

About 3 E

side of E the lake

tree 5 inches diameter, on the N

Metal Location Poster is on a

Rock

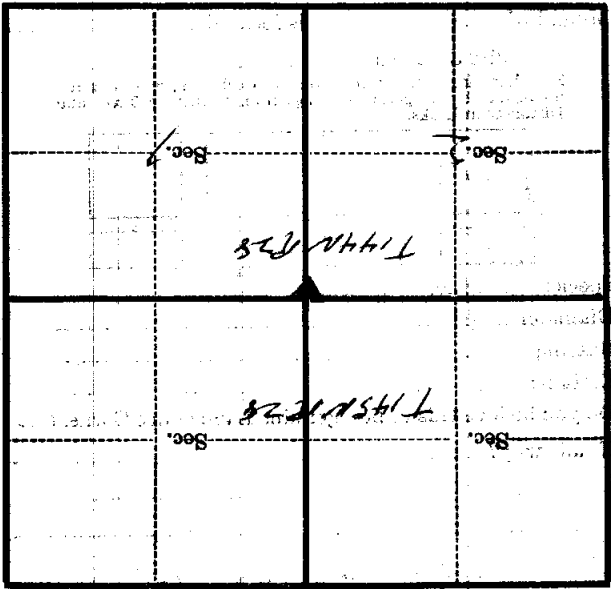

(Make sketch of topography near Corner)