

U. S. Department of Agriculture

FOREST SERVICE

posted

Company NATIONAL FOREST

V-19

CORNERS OF THE PUBLIC SURVEY

T. *144* R. *28* S. *5* Mer.

1/4 Corner common to Sections *26, 35* and *36*

Corner consists of a *wood stake* (not) in place
State condition *good*

Dimensions above ground *3.28* inches.

Sketch grooves, letters, figures, or notches, on proper face or edge.

CARDINAL POSITION

DIAGONAL POSITION

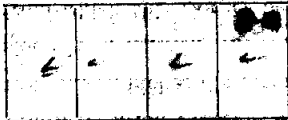

N W S E

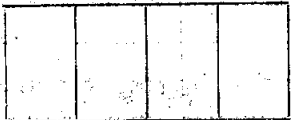

NW SW SE NE

Mound of *stone* is located

Pits are located

Sketch markings of Bearing Trees (or Rocks) in proper box and fill blanks below, giving bearings from Corner to Trees and Distances in Links.

<i>Yes</i>	<i>1/4 S</i>		
<i>Dead</i>	<i>Dead</i>		
<i>BT</i>	<i>BT</i>		

Species *J. Pine Norway*

Diameter *9* *15*

Bearing

Distance *9 paces* *15 paces*

Do you believe this to be a genuine Land Office Corner? *Yes*

If not, why? *Not original corner*

R. W. Williams

10/17/33

(Date)

(Title)

Corner again.
 4 Pine pole stand
 3 chains to the East
 begins road turns
 at corner

Metal Location Poster is on a
 tree 10" inches diameter, on the
 side of
 from which this Corner bears
 103° 22' chains distant.
 Give any further facts which will aid in finding this

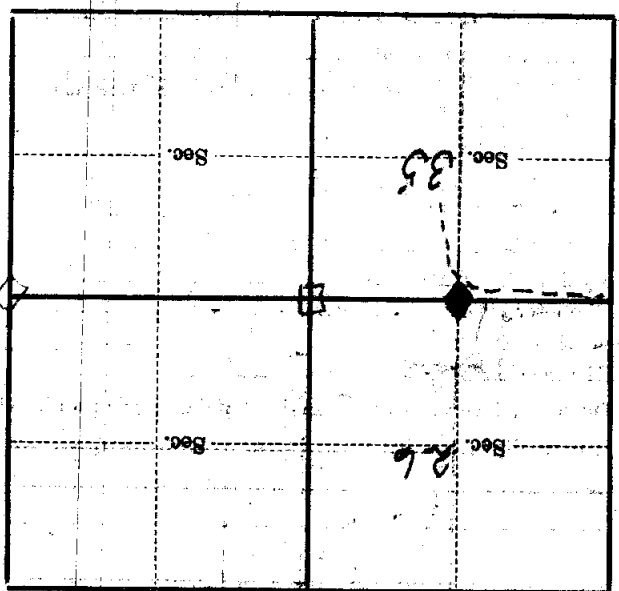

(Make sketch of topography near Corner)

U. S. DEPARTMENT OF AGRICULTURE
FOREST SERVICE

Posted
V-19

Minor NATIONAL FOREST

CORNERS OF THE PUBLIC SURVEY

T: 144 R. 28 5 Mer.

1/4 Corner common to Sections
26, and 35

DESCRIPTION OF CORNER

Corner consists of a square post

Dimension above ground 3' inches

Sketch grooves, letters, figures, or notches, on proper face or edge.

CARDINAL POSITION

DIAGONAL POSITION

<u>marked 1/4 cor</u>			
N	W	S	E

<u>marked post</u>			
NW	SW	SE	NE

Mound of _____ is located _____

Pits are located _____

Sketch markings of Bearing Trees (or Rocks) in proper box and fill blanks below, giving bearings from Corner to Trees and Distances in Links.

<u>BT</u>			

Species Bo

Diameter 5 1/2 high stump 14" dia

Bearing S 5 W

Distance _____

Do you believe this to be a genuine Land Office Corner?

If not, why? No original post

L Henry
Mar 2 1928

[Signature]
Signature
JF

Date.

Title.

T. W. R. 28
Mer.

9-3027 (Make sketch of topography near Corner.)

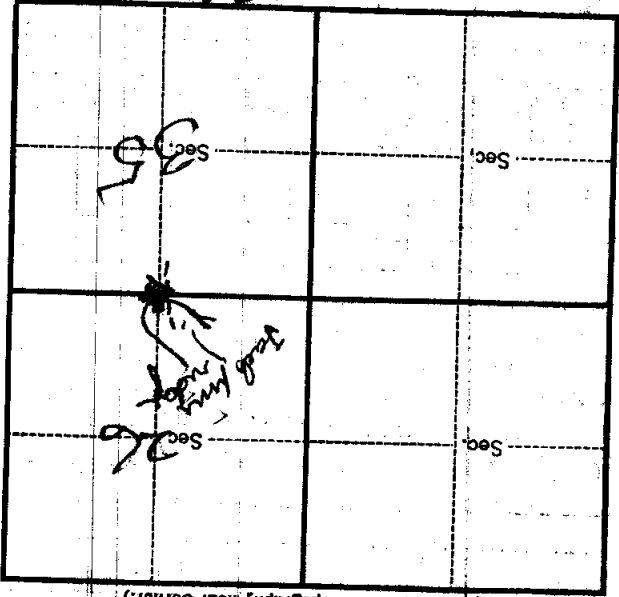

Metal Location Poster is on a *Jack Pine*

tree ^{9"} inches diameter, on the *N*

side of *N 45 line*

from which this Corner bears

20 65 chains distant

Give any further facts which will aid in finding this

Corner again.

Survey on all corners
95
Henry 1/4 corner