

U. S. Department of Agriculture
FOREST SERVICE

V-16

Chippewa NATIONAL FOREST

CORNERS OF THE PUBLIC SURVEY

T. *149* R. *28* *5th P.* Mer.

Sixteenth E. *116* Corner common to Sections
27, and *34*

Corner consists of a *yellow tag* (not) in place
State condition *good*

Dimensions above ground *54* inches

Sketch grooves, letters, figures, or notches, on proper face or edge.

CARDINAL POSITION

DIAGONAL POSITION

--	--	--	--

--	--	--	--

N W S E

NW SW SE NE

Mound of _____ is located _____

Pits are located _____

Sketch markings of Bearing Trees (or Rocks) in proper box and fill blanks below, giving bearings from Corner to Trees and Distances in Links.

Species _____

Diameter _____

Bearing _____

Distance _____

Do you believe this to be a genuine Land Office Corner? *Yes*

If not, why? *No evidence found*

Martin K. Luntz

(Signature)

Asst Dist For Ranger

(Title)

1/26/59
(Date)

V-16

Corner again.
 This point is the same
 See Corner corner & S. 25, 27, 30
 \$ 35.

Give any further facts which will aid in finding this
~~point~~ distant.
 from which this Corner bears
 W 15 ^{1/2} E
 side of
 tree ^{tree} inches diameter, on the ^{East}
 Metal Location Poster is on a ^{corner}

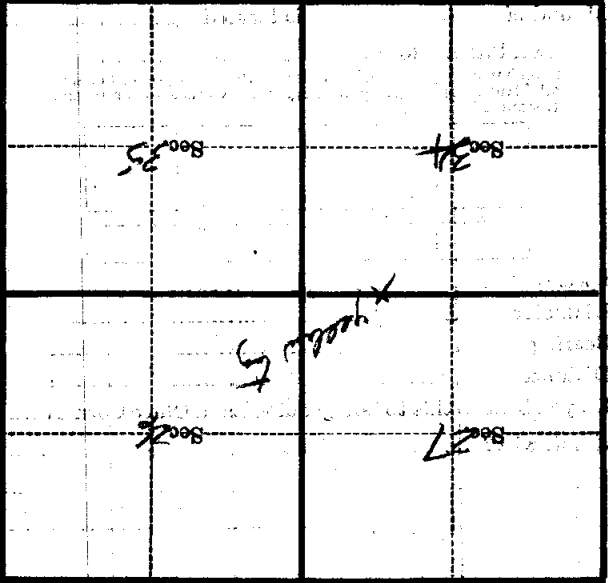

(Make sketch of topography near Corner)