

U. S. Department of Agriculture

FOREST SERVICE

R-15

NATIONAL FOREST

CORNERS OF THE PUBLIC SURVEY

T. 144 R. 28 5<sup>th</sup> Mer.

Corner common to Sections 22, 27, and

Corner consists of a squared post (not) in place State condition laying down

Dimensions above ground inches

Sketch grooves, letters, figures, or notches, on proper face or edge.

CARDINAL POSITION

DIAGONAL POSITION

Grid for cardinal positions: N, W, S, E

Grid for diagonal positions: NW, SW, SE, NE

N W S E

NW SW SE NE

Mound of is located

Pits are located

Sketch markings of Bearing Trees (or Rocks) in proper box and fill blanks below, giving bearings from Corner to Trees and Distances in Links.

Grid for sketching bearing trees and rocks

Species

Diameter

Bearing

Distance

Do you believe this to be a genuine Land Office Corner?

If not, why?

Stanley M. Morrison

(Signature)

G. D. A.

(Title)

2/13/58

(Date)

SECTION 7  
SECTION 2

Corner again  
from center of  
line 22 South

Give any further facts which will aid in finding this

1/4 Sec. 7 contains distant

from which this Corner bears  
South

side of tree

Metal Location Poster is on a  
tree 8 inches diameter, on the  
South

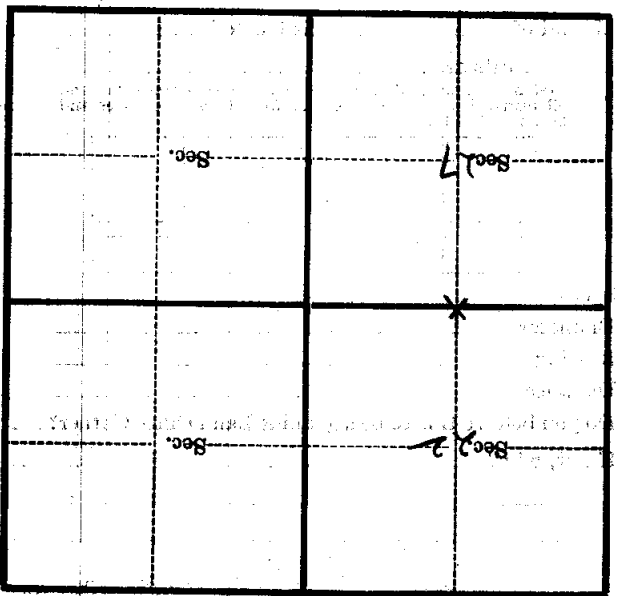

(Make sketch of topography near Corner)

U. S. DEPARTMENT OF AGRICULTURE  
FOREST SERVICE

*Posted*  
*R-15*

Minn. NATIONAL FOREST

CORNERS OF THE PUBLIC SURVEY

T. 144 R. 28 S. 5 Mer.

Corner common to Sections  
22 and 27

DESCRIPTION OF CORNER

Corner consists of a old tam notch <sup>*1/4 marked*</sup> <sub>*lightly*</sub>

Dimension above ground 24 inches.  
Sketch grooves, letters, figures, or notches, on proper face or edge.

CARDINAL POSITION

DIAGONAL POSITION

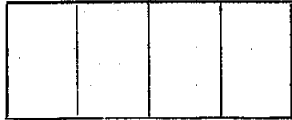

N W S E NW SW SE NE

Mound of \_\_\_\_\_ is located \_\_\_\_\_

Pits are located \_\_\_\_\_

Sketch markings of Bearing Trees (or Rocks) in proper box and fill blanks below, giving bearings from Corner to Trees and Distances in Links.



BT \_\_\_\_\_

Species Tam living  
Diameter 10  
Bearing N10W  
Distance 20L

Do you believe this to be a genuine Land Office Corner? Yes

If not, why? \_\_\_\_\_

*[Signature]*

Signature

3-28-28

Date.

Title. R-15 9-3027

T. 144 R. 28 Mer. 5

8-2027 (Make sketch of topography near Corner.)

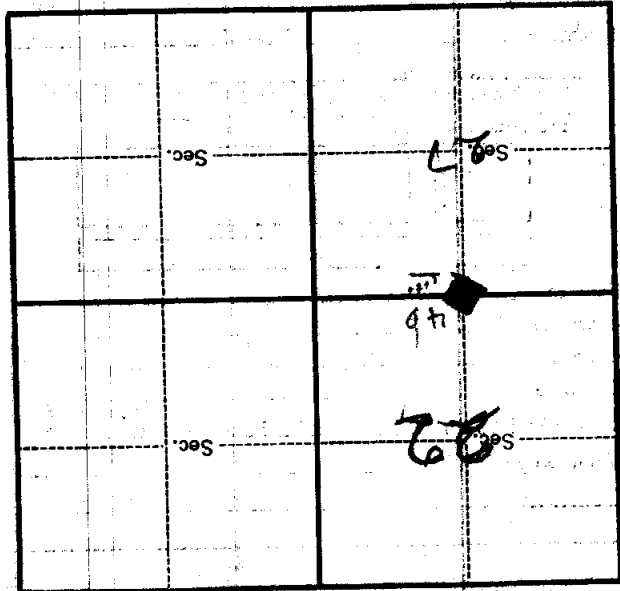

Metal Location Poster is on a

tree inches diameter, on the

side of

from which this Corner bears

chains distant.

Give any further facts which will aid in finding this

Corner again.

~~Sec. 2~~  
~~Sec. 7~~

Section corner poster

located at