

Form 874-0—Revised May, 1918
 U. S. Department of Agriculture
 FOREST SERVICE

N-25

NATIONAL FOREST
 CORNERS OF THE PUBLIC SURVEY

T. 144 R. 27 Mer.

Section Corner common to Sections
13, 24, and 18+19 T144 R26

Corner consists of a Brass Cap in concrete post in place

State condition good

Dimensions above ground 4 inches

Sketch grooves, letters, figures, or notches, on proper face or edge.

CARDINAL POSITION

DIAGONAL POSITION

--	--	--	--

N W S E

--	--	--	--

NW SW SE NE

Mound of _____ is located _____

Pits are located _____

Sketch markings of Bearing Trees (or Rocks) in proper box and fill blanks below, giving bearings from Corner to Trees and Distances in Links.

Species	<u>STump</u>	<u>R.P.</u>	<u>R.P.</u>	
Diameter	<u>10"-3"3T</u>	<u>12"</u>	<u>16"</u>	
Bearing	<u>N70W</u>	<u>N30E</u>	<u>S50E</u>	
Distance	<u>551Ms</u>	<u>611Ms</u>	<u>501Ms</u>	

Do you believe this to be a genuine Land Office Corner? Yes

If not, why? _____

R. H. ...

(Signature)

1-16-58
 (Date)

R. E. ...
 (Title)

Corner again.
Blaze & painted lines N-S-E-W
In pine stand E & N of
grass & water.

Give any further facts which will aid in finding this
chains distant.
from which this Corner bears
side of
tree 14 inches diameter, on the S W
Metal Location Poster is on a *White Pine*

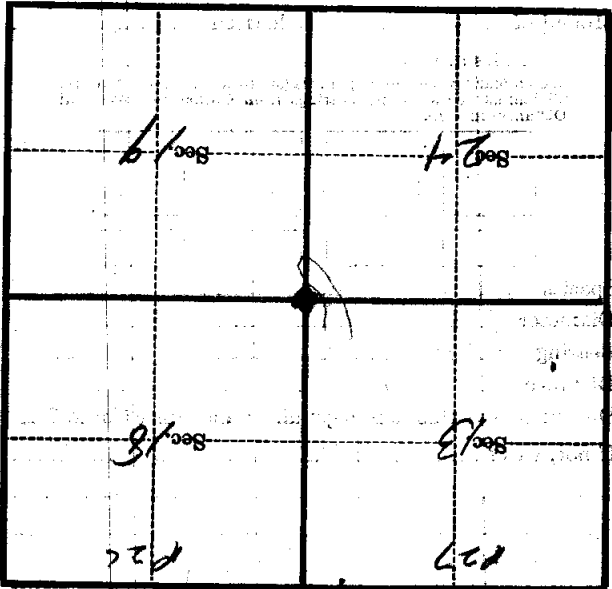

(Make sketch of topography near Corner)

T. 144 R. Mer.