

U. S. Department of Agriculture

FOREST SERVICE

1918

Chippewa NATIONAL FOREST

CORNERS OF THE PUBLIC SURVEY

T. 14AN R. 26W 5th Mer.

Corner common to Sections

_____, _____, _____, and 1A

Corner consists of a _____ (not) in place

State condition None found

Dimensions above ground _____ inches

Sketch grooves, letters, figures, or notches, on proper face or edge.

CARDINAL POSITION

DIAGONAL POSITION

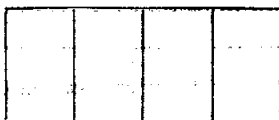
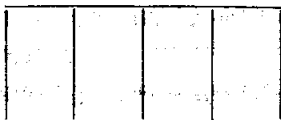

Mound of _____ is located _____

Pits are located _____

Sketch markings of Bearing Trees (or Rocks) in proper box and fill blanks below, giving bearings from Corner to Trees and Distances in Links.



Species _____

Diameter _____

Bearing _____

Distance _____

Do you believe this to be a genuine Land Office Corner? No

If not, why? No evidence found

[Handwritten Signature]

(Signature)

Asst DFR

(Title)

4/9/61
(Date)

Blk. 114 R. 26W
2 1/2 miles south of corner

Corner again.

Give any further facts which will aid in finding this chains distant.

from which this Corner bears

side of ~~Tree~~

tree 2 inches diameter, on the ~~West~~

Metal Location Poster is on a ~~white oak~~

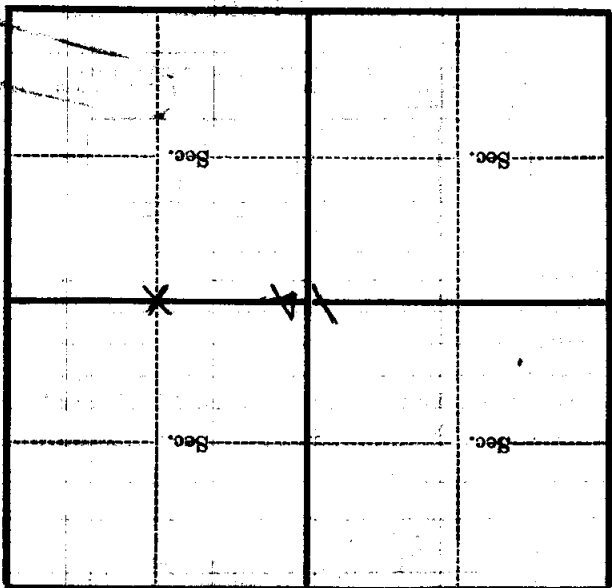

(Make sketch of topography near Corner)

T. 144 N. R. 26 W. 57N Mer.

U. S. Department of Agriculture

FOREST SERVICE

4-21
11-18-26
123

Chippewa NATIONAL FOREST

CORNERS OF THE PUBLIC SURVEY

T. 144 R. 26 S. 16 Mer.

416 Corner common to Sections 13, and 14

Corner consists of a No Stake (not) in place State condition

Dimensions above ground inches

Sketch grooves, letters, figures, or notches, on proper face or edge.

CARDINAL POSITION

DIAGONAL POSITION

--	--	--	--

N W S E

--	--	--	--

NW SW SE NE

Mound of Is located

Pits are located

Sketch markings of Bearing Trees (or Rocks) in proper box and fill blanks below, giving bearings from Corner to Trees and Distances in Links.

M.C.

M.C.
S 13

B.T.

B.T.

Species

Jack Pine STUB

Jack Pine STUB

Diameter

10"

16"

Bearing

N.W.

N.E.

Distance

Do you believe this to be a genuine Land Office Corner? Yes

If not, why?

H. E. Johnson

(Signature)

Aug. 7-1929

(Date)

Estimator

(Title)

L-21

Corner again.
Directly across river from
School house

Give any further facts which will aid in finding this
chains distant.
From which this Corner bears
side of North + South line
tree 12 inches diameter, on the East
Metal Location Poster is on a Jack Pine

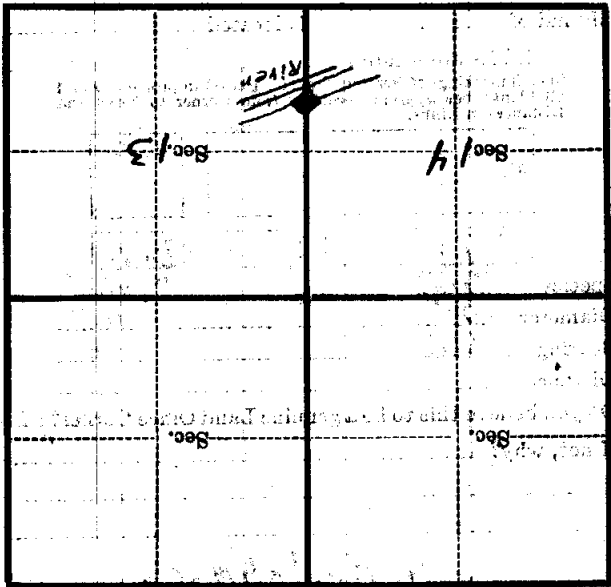

(Make sketch of topography near Corner)

T. 144 R. 26 S. 74
Mgt.

Form 874-9—Revised May, 1918
U. S. Department of Agriculture
FOREST SERVICE

L-21

Chippewa NATIONAL FOREST

CORNERS OF THE PUBLIC SURVEY

T. 144N R. 26W 5th P Mer.

116 Corner common to Sections
13, and 14

Corner consists of a No stake (not) in place
State condition

Dimensions above ground inches
Sketch grooves, letters, figures, or notches, on proper face or edge.

CARDINAL POSITION

DIAGONAL POSITION

N	W	S	E

NW	SW	SE	NE

Mound of is located

Pits are located

Sketch markings of Bearing Trees (or Rocks) in proper box and fill blanks below, giving bearings from Corner to Trees and Distances in Links.

M.C.			M.C. 513
B.T.			B.T.

Species J. Pinestub J. Pinestub

Diameter 10" 16"

Bearing NW NE

Distance

Do you believe this to be a genuine Land Office Corner? Yes

If not, why?

H. E. Johnson

(Signature)

Estimator

(Title)

Aug-7-1929
(Date)

(Date sketch of topography near Corner)

T. 144 R. 26 S. 54 Mer.

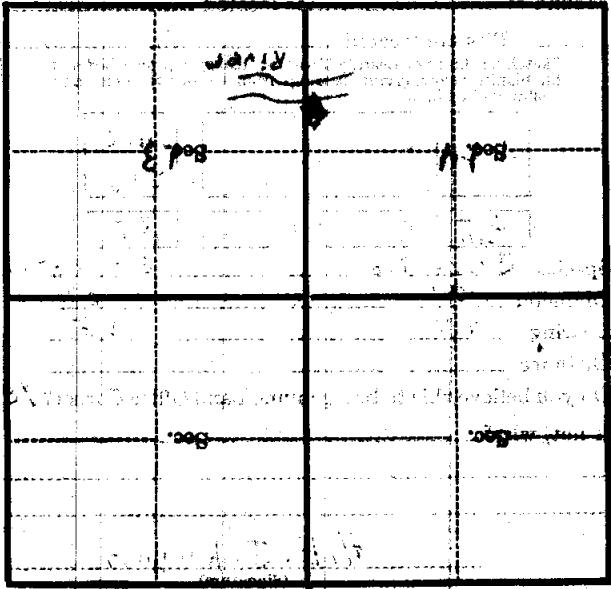

Metal Location Poster is on a

tree 12 inches diameter, on the East side of N & S line

from which this Corner bears

chains distant

Give any further facts which will aid in finding this

Corner again.

Directly across river from school house.

U. S. Department of Agriculture

FOREST SERVICE

L-21

Chippewa

NATIONAL FOREST

CORNERS OF THE PUBLIC SURVEY

T. 144 N. R. 26 W. Mer.

1/4 Corner consists of Sections

11, 12, 13, and 14

Corner consists of a (not) in place

State condition New treated post

Dimensions above ground inches

Sketch grooves, letters, figures, or notches, on proper face or edge.

CARDINAL POSITION

DIAGONAL POSITION

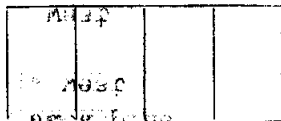
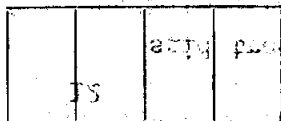

Mound of is located

Pits are located

Sketch markings of Bearing Trees (or Rocks) in proper box and fill blanks below, giving bearings from Corner to Trees and Distances in Links.

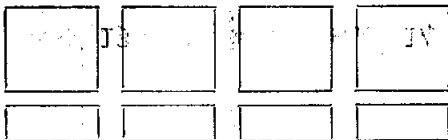

Species

Diameter

Bearing

Distance

Do you believe this to be a genuine Land Office Corner?

If not, why?

Believed to be very close but there was no conclusive evidence.

Ray W. Jasunt (Signature)

Sept 1918 (Date)

(Title)

L-21

CHIEF

ORIGINAL M.C. and 1/4 Cor. witness trees.
by the 1951 search crew after careful
"1/4 13/17". This point was designated
Set 7 post 3/4 feet high and oriented
Corner again. New created post

Give any further facts which will aid in finding this
chains distant.
0.46
from which this Corner bears
side of
said tree
tree 12 inches diameter, on the west
Metal Location Poster is on a
Jack pine

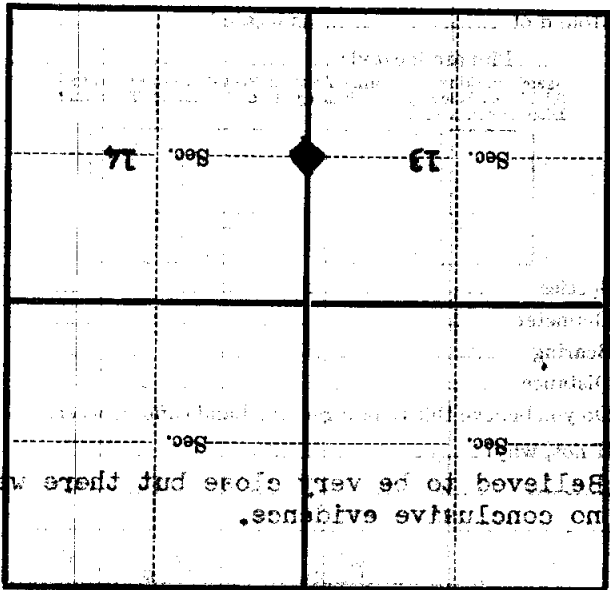

(Make sketch of topography near Corner)

U. S. Department of Agriculture

FOREST SERVICE

Chippewa

NATIONAL FOREST

L-21

CORNERS OF THE PUBLIC SURVEY

T. 144 N. R. 26 W. Mer.1/4

Corner common to Sections

1314

Corner consists of a _____ (not) in place

State condition New treated post

Dimensions above ground _____ inches

Sketch grooves, letters, figures, or notches, on proper face or edge.

CARDINAL POSITION

DIAGONAL POSITION

N	W	S	E

NW	SW	SE	NE

Mound of _____ is located _____

Pits are located _____

Sketch markings of Bearing Trees (or Rocks) in proper box and fill blanks below, giving bearings from Corner to Trees and Distances in Links.

Species _____

Diameter _____

Bearing _____

Distance _____

Do you believe this to be a genuine Land Office Corner? _____

If not, why? _____

Believed to be very close but there was no conclusive evidence.F. J. S. S. S.

(Signature)

53

(Date)

(Title)

Set 4 post 3/4 feet high and scribed
1/4 13/17. This point was designated
by the 1951 search crew after careful
measurement from probable remains of
original M.C. and 1/4 Cor. witness trees.

Corner again.

Give any further facts which will aid in finding this

chains distant.

0.76

from which this Corner bears

west

side of

said tree

tree 12 inches diameter, on the west

Metal Location Poster is on a Jack pine

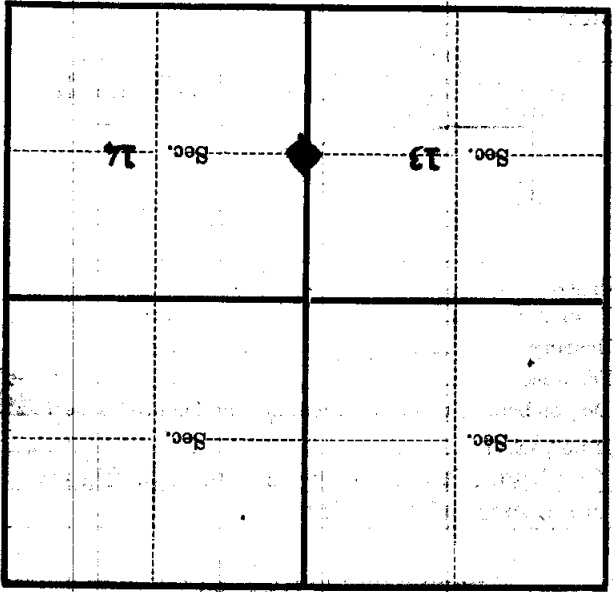

(Make sketch of topography near Corner)