

U. S. Department of Agriculture
FOREST SERVICE

11-16-34
2129
-13

Chippewa NATIONAL FOREST

CORNERS OF THE PUBLIC SURVEY

T. 144 R. 26 5th Mer.

Sec Corner common to Sections

33, and 34

Corner consists of a Wooden Post (not) in place

State condition Good

Dimensions above ground 36 inches

Sketch grooves, letters, figures, or notches, on proper face or edge.

CARDINAL POSITION

DIAGONAL POSITION

--	--	--	--

T144			R26
533			9.34

N W S E

NW SW SE NE

Mound of _____ is located _____

Pits are located _____

Sketch markings of Bearing Trees (or Rocks) in proper box and fill blanks below, giving bearings from Corner to Trees and Distances in Links.

Species _____

Diameter _____

Bearing _____

Distance _____

Do you believe this to be a genuine Land Office Corner? YES

If not, why? _____

H. A. Brills

(Signature)

Chief of Party

(Title)

7/26/34
(Date)

COMMITTEE ON THE PUBLIC SERVICE

REPORT ON THE PUBLIC SERVICE

Corner again.

Give any further facts which will aid in finding this chains distant.

From which this Corner bears side of

tree inches diameter, on the

Metal Location Poster is on a

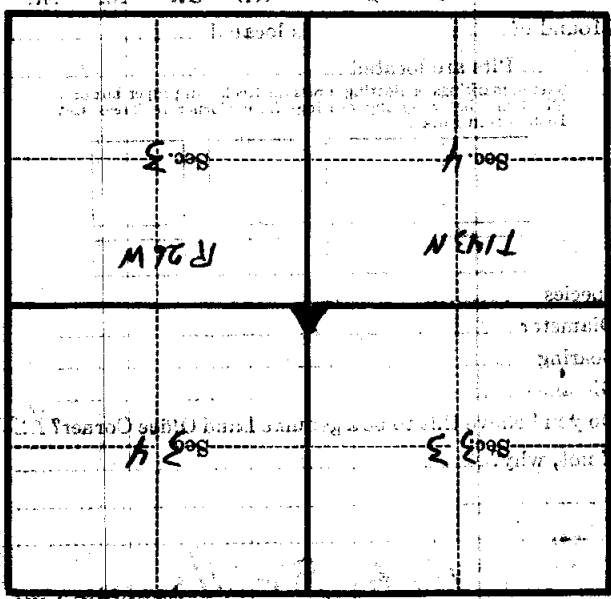

(Make sketch of topography near Corner)

Corner is on R.R. at point 0.07 ch. S. of center of track, marked by 2x2 stake near end of R.R. tie. Stake projects about 5 inches. Put PSIP tag on telephone pole No. 4131 from which corner is SW 1.91 ch.

Corner again.

Give any further facts which will aid in finding this corner again.

from which this corner bears

side of

tree inches diameter, on the

Metal Location Poster is on a

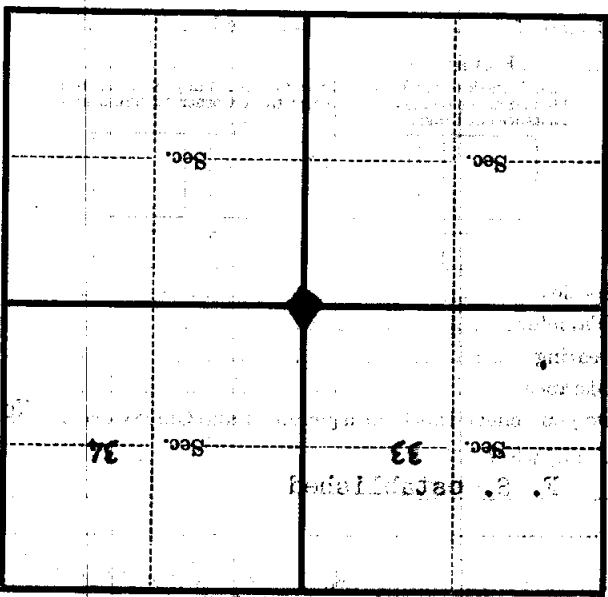

(Make sketch of topography near corner)