

U. S. Department of Agriculture
FOREST SERVICE

Posted

Chippewa NATIONAL FOREST *A21*

CORNERS OF THE PUBLIC SURVEY

T. *744-193* R. *31 W* *5th* Mer.

Section Corner common to Sections
35, 36, 2, and 1

Corner consists of a *2" capped pipe* (not) in place
State condition *good*

Dimensions above ground *12* inches

Sketch grooves, letters, figures, or notches, on proper face or edge.

CARDINAL POSITION

DIAGONAL POSITION

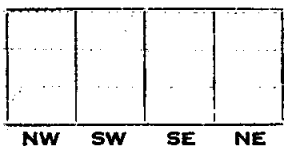
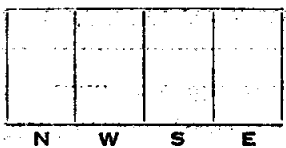

Mound of _____ is located _____

Pits are located _____

Sketch markings of Bearing Trees (or Rocks) in proper box and fill blanks below, giving bearings from Corner to Trees and Distances in Links.

<i>1</i>				
<i>S. 36</i>	<i>S 35</i>	<i>S 35</i>	<i>S. 2.</i>	<i>51</i>

<i>Stamp</i>	<i>B.T.</i>	<i>B.T.</i>	<i>B.T.</i>	<i>B.T.</i>	<i>B.T.</i>
--------------	-------------	-------------	-------------	-------------	-------------

Species	<i>Tamarack?</i>	<i>Red Spruce</i>	<i>Stamp Spruce</i>	<i>Stamp Tamarack</i>	<i>Cedar</i>
Diameter	<i>8"</i>	<i>4"</i>	<i>6"</i>	<i>8"</i>	<i>6"</i>
Bearing	<i>N40 1/2 E</i>	<i>N39 1/4 W</i>	<i>N89° W</i>	<i>S51 1/2 W</i>	<i>S59 1/2 E</i>
Distance	<i>25</i>	<i>11</i>	<i>5 3/4</i>	<i>39 3/4</i>	<i>56</i>

Do you believe this to be a genuine Land Office Corner? *yes.*

If not, why? _____

Dan. Co. Rose
(Signature)

8/15/39.
(Date)

Compassman
(Title)

Faint, illegible text on a grid background, possibly bleed-through from the reverse side of the page.

Corner again.

Give any further facts which will aid in finding this

chain distant.

56

from which this Corner bears ^{LK 7} N 69 1/2° W

side of

tree 6 inches diameter, on the

Metal Location Poster is on a W Cedar

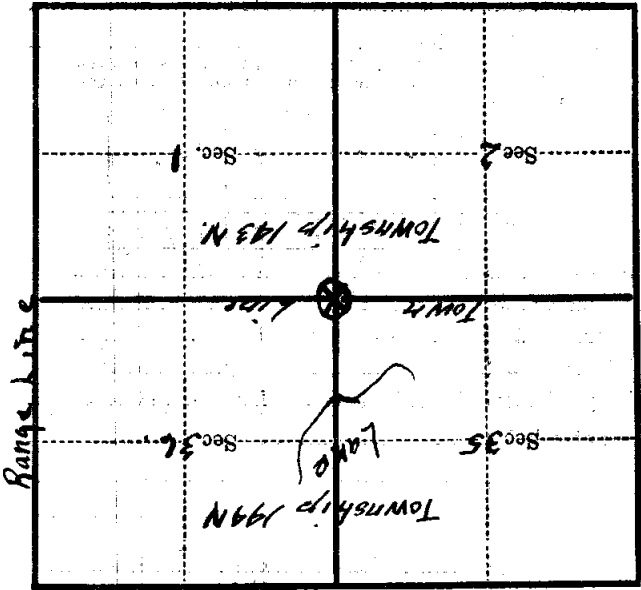

(Make sketch of topography near Corner)

A-21

Mer. 574

T 199-193N R. 31W