

U. S. Department of Agriculture

FOREST SERVICE

Posted

T21

Chippewa NATIONAL FOREST

CORNERS OF THE PUBLIC SURVEY

T. *143N.* R. *30W.* *524* Mer.

Quarter Corner common to Sections
.....,, *26*, and *25*

Corner consists of a *Brass Caped Pip* (not) in place

State condition *Good*

Dimensions above ground *14"* inches

Sketch grooves, letters, figures, or notches, on proper face or edge.

CARDINAL POSITION

DIAGONAL POSITION

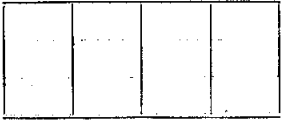
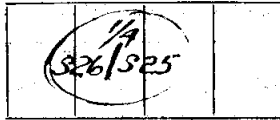

N W S E

NW SW SE NE

Mound of is located

Pits are located

Sketch markings of Bearing Trees (or Rocks) in proper box and fill blanks below, giving bearings from Corner to Trees and Distances in Links.

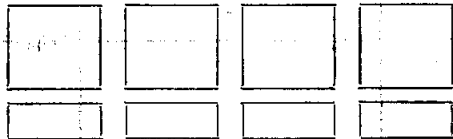

Species *No B.Ts.*

Diameter

Bearing *Open*

Distance

Do you believe this to be a genuine Land Office Corner? *Yes.*

If not, why?

J.A. Gielhang

(Signature)

12/5/34

(Date)

Tech. Eng.

(Title)

.....
.....
.....
.....
.....

Corner again.
Set 3" oak post by
Brass Coped Pipe as a
marker.

Give any further facts which will aid in finding this
chains distant.
from which this Corner bears
side of
tree inches diameter, on the
Metal Location Poster is on a

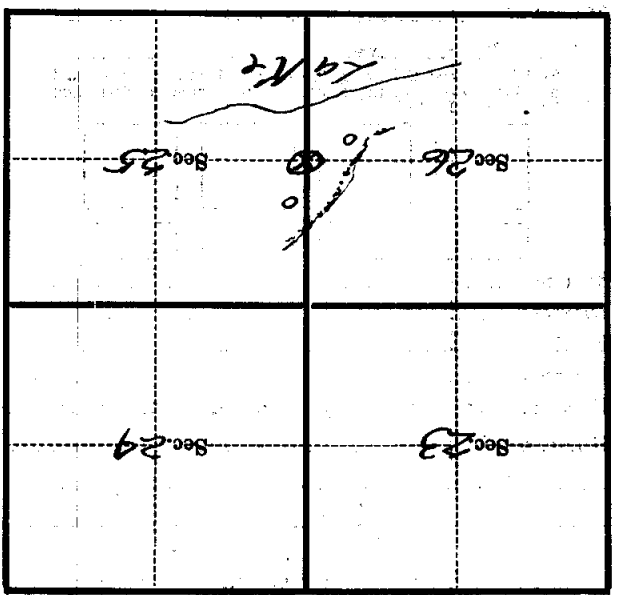

(Make sketch of topography near Corner)

T-21

T. 143N. R. 31W. S. 72N Mer.