

U. S. Department of Agriculture

FOREST SERVICE

posted.

Chippewa NATIONAL FOREST

CORNERS OF THE PUBLIC SURVEY

T. 143 N R. 30 W S Mer.

Quarter Corner common to Sections

Corner consists of a Metal Hub (set) in place

State condition good

Dimensions above ground 11 inches.

Sketch grooves, letters, figures, or notches, on proper face or edge.

CARDINAL POSITION

DIAGONAL POSITION

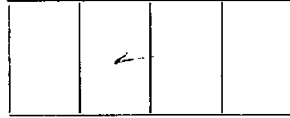
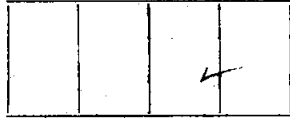

Mound of is located

Pits are located

Sketch markings of Bearing Trees (or Rocks) in proper box and fill blanks below, giving bearings from Corner to Trees and Distances in Links.

| | | | |
|-------|----------------|--|--|
| S 9 | S 4 Not Found. | | |
| B. T. | | | |

Species Elm Stump 2 1/2" high

Diameter 2 1/2"

Bearing S 45° W

Distance 18'

Do you believe this to be a genuine Land Office Corner? Yes

If not, why?

Handwritten signature and name

11.01.23.1931

(Date)

(This)

Metal Location Poster is on a tree inches diameter, on the side of from which this Corner bears chains distant.

Give any further facts which will aid in finding this Corner again.

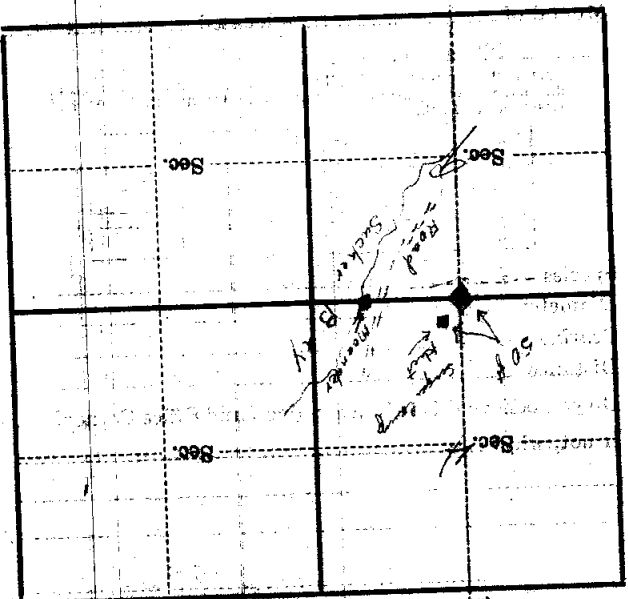

(Make sketch of topography near Corner)

T. 145 N. R. 31 W. Mer.

U. S. Department of Agriculture

FOREST SERVICE

Posted

E11

Chippewa NATIONAL FOREST

CORNERS OF THE PUBLIC SURVEY

T. 143N R. 30W 5th Mer.

Quarter Corner common to Sections

.....,, 4, and 9

Corner consists of a *Br. cap. iron pipe (not)* in place

State condition *good*

Dimensions above ground *1x8* inches

Sketch grooves, letters, figures, or notches, on proper face or edge.

CARDINAL POSITION

DIAGONAL POSITION

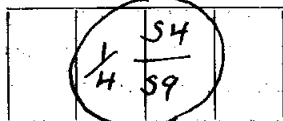

N W S E NW SW SE NE

Mound of is located

Pits are located

Sketch markings of Bearing Trees (or Rocks) in proper box and fill blanks below, giving bearings from Corner to Trees and Distances in Links.

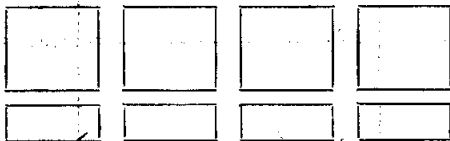

Species: *No B.T.s*

Diameter

Bearing

Distance

Do you believe this to be a genuine Land Office Corner?

If not, why?

Dorman J. Sutton
(Signature)

(Date)

(Title)

Corner again.

Give any further facts which will aid in finding this

chains distant. 14

from which this Corner bears 56° 15' E

side of tree

tree 26 inches diameter, on the S.E.

Metal Location Poster is on a H. Maple

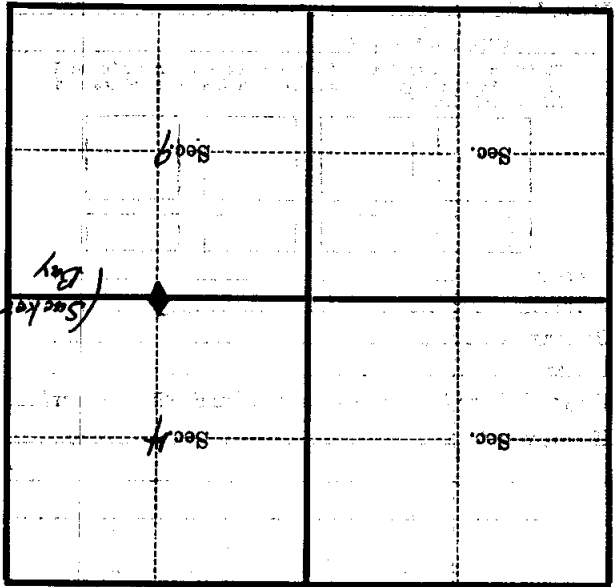

(Make sketch of topography near Corner)

T. 1173N R. 30W 5th Mer. E-11