

U. S. Department of Agriculture  
FOREST SERVICE

E-3

E3

Posted

Chippewa NATIONAL FOREST

CORNERS OF THE PUBLIC SURVEY

T. 143 N. R. 30 W. 5<sup>th</sup> Mer.

Quarter Corner common to Sections

6, and 7

Corner consists of 1/2" cap iron pipe (set) in place

State condition good

Dimensions above ground 1.6 inches

Sketch grooves, letters, figures, or notches, on proper face or edge.

CARDINAL POSITION

DIAGONAL POSITION

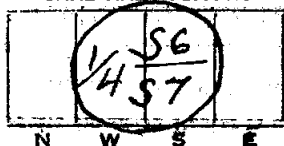

Mound of \_\_\_\_\_ is located \_\_\_\_\_

Pits are located \_\_\_\_\_

Sketch markings of Bearing Trees (or Rocks) in proper box and fill blanks below giving bearings from Corner to Trees and Distances in Feet.

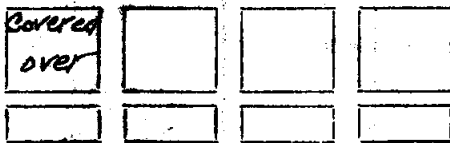

Species W. Oak

Diameter 1 1/4"

Bearing N 32° E

Distance 21

Do you believe this to be a genuine Land Office Corner? Yes

If not, why? \_\_\_\_\_

Dorman J. Sutton

1-3-35  
(Date)

Compassman  
(Title)

-----

-----

-----

-----

-----

-----

-----

-----

-----

-----

Corner again.

Give any further facts which will aid in finding this

chains distant.

21

from which this Corner bears S 32.0 W

side of tree

tree 14 inches diameter, on the S W

Metal Location Poster is on a W Oak

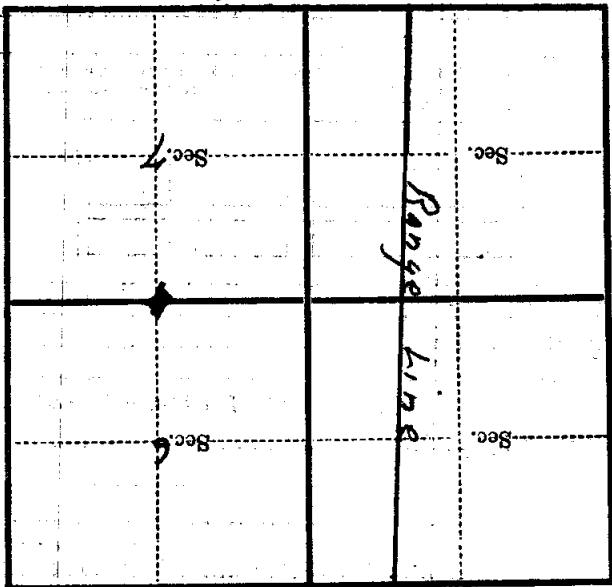

(Make sketch of topography near Corner)