

U. S. Department of Agriculture

FOREST SERVICE

Posted

Chippewa NATIONAL FOREST H2

CORNERS OF THE PUBLIC SURVEY

T. 143N R. 30W 5th Mer.
Sixteenth Corner common to Sections

7, , and

Corner consists of a Br. cap. iron pipe (not) in place

State condition good

Dimensions above ground 1 x 1 1/4 inches

Sketch grooves, letters, figures, or notches, on proper face or edge.

CARDINAL POSITION

DIAGONAL POSITION

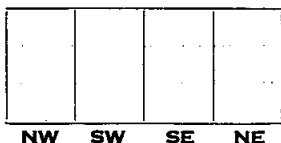
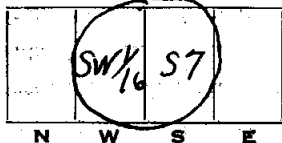

Mound of is located

Pits are located

Sketch markings of Bearing Trees (or Rocks) in proper box and fill blanks below, giving bearings from Corner to Trees and Distances in Links.



Species Birch Birch-stub

Diameter 8 4

Bearing N 67° 45' E S 64° W

Distance 30 1/2 41

Do you believe this to be a genuine Land Office Corner? Yes

If not, why?

Dorman J. Sutton

(Signature)

12-12-34

(Date)

Compressman

(Title)

Corner again.

Give any further facts which will aid in finding this

³⁸³ chains distant.

from which this corner bears $S 67^{\circ} 45' W$ side of tree

tree 8 inches diameter, on the SW Metal Location Poster is on a Birch

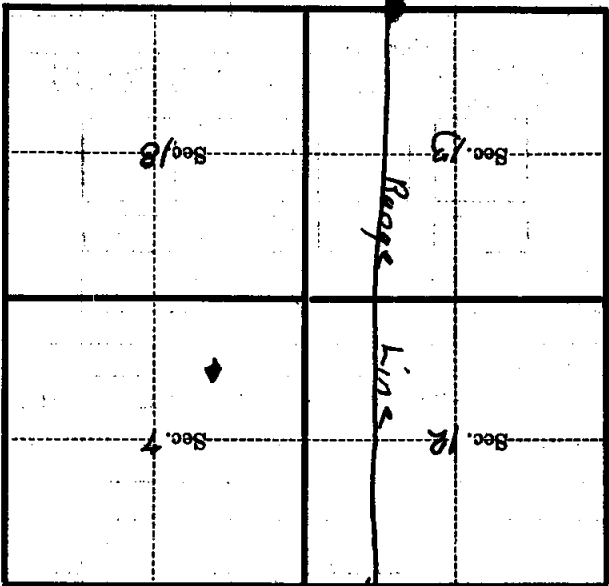

(Make sketch of topography near Corner)

T. 143N R. 30W S. 7th Mer. H-2