

Form 874-B—Revised May, 1918  
U. S. Department of Agriculture  
FOREST SERVICE

J-K-19  
A 2

Chippewa NATIONAL FOREST

CORNERS OF THE PUBLIC SURVEY

T. 143 N R. 29 W \_\_\_\_\_ 5 Mer.

G.L.O Meander Corner common to Sections  
14 (Lake Park), and \_\_\_\_\_

Corner consists of a Iron post ~~( )~~ in place  
State condition Good.

Dimensions above ground 14 inches

Sketch grooves, letters, figures, or notches, on proper face or edge.

CARDINAL POSITION

DIAGONAL POSITION

--	--	--	--

N W S E

U.S. G.L.O. Survey			
T 143 N. S. & L 14 W. C.			
R 29 W			

NW SW SE NE

Mound of \_\_\_\_\_ is located \_\_\_\_\_

Pits are located \_\_\_\_\_

Sketch markings of Bearing Trees (or Rocks) in proper box and fill blanks below, giving bearings from Corner to Trees and Distances in Links.

No	B. T. 's		

Species \_\_\_\_\_

Diameter \_\_\_\_\_

Bearing \_\_\_\_\_

Distance \_\_\_\_\_

Do you believe this to be a genuine Land Office Corner? Yes

If not, why? \_\_\_\_\_

Maurice Schaller

(Signature)

(Date)

(Title)

J-K-19

Wire Fence E & W.

Corner again.

Give any further facts which will aid in finding this

14 Links chains distant.

from which this Corner bears

S50°E

side of Tree

tree 18 inches diameter, on the SE

Metal Location Poster is on a

FLM

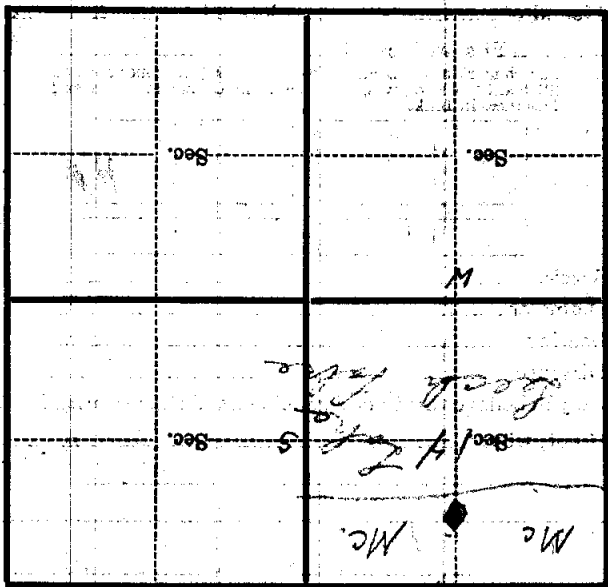

(Make sketch of topography near Corner)

T. 143N R. 29W

JK-19