

Form 574-B—Revised May, 1918  
U. S. Department of Agriculture  
FOREST SERVICE

W  
P. A-17

*Chippewa* NATIONAL FOREST  
CORNERS OF THE PUBLIC SURVEY

T. *143N* R. *28W* S. Mer.  
*Section* Corner common to Sections  
*34, 35, 3, and 2*

Corner consists of a *in road* (no) in place  
State condition *in road (buried)*

Dimensions above ground *buried* inches  
Sketch grooves, letters, figures, or notches, on proper face or edge.

CARDINAL POSITION

DIAGONAL POSITION

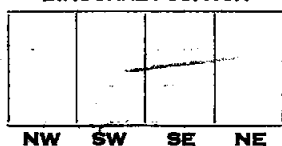
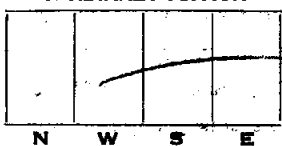

Mound of \_\_\_\_\_ is located \_\_\_\_\_

Pits are located \_\_\_\_\_

Sketch markings of Bearing Trees (or Rocks) in proper box and  
fill blanks below, giving bearings from Corner to Trees and  
Distances in Links.

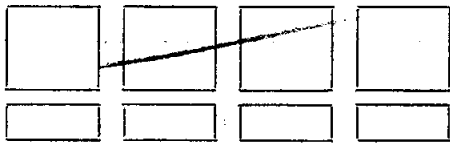

Species \_\_\_\_\_  
Diameter \_\_\_\_\_  
Bearing \_\_\_\_\_  
Distance \_\_\_\_\_

Do you believe this to be a genuine Land Office Corner? *No*

If not, why? *Set in road  
after road was  
built Robert Penick*

*7/16/35*  
(Date)

*Estimate*  
(Title)

*2 1/2 to 3 Ed*  
*mark*

Corner again.

Give any further facts which will aid in finding this

chains distant.

from which this Corner bears

side of

*front*  
tree *1* inches diameter, on the

Metal Location Poster is on a

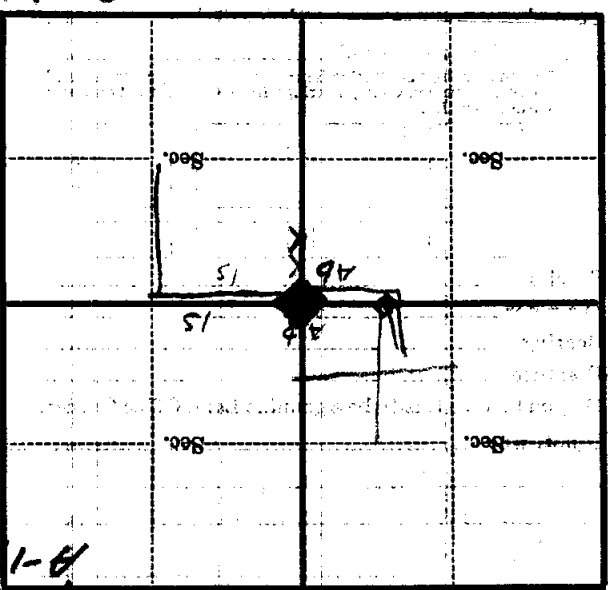

(Make sketch of topography near Corner)

Mer.

*5*  
*1 1/2 N*  
*R 2 SW*  
*14*

*B-17*