

Form 874-B—Revised May, 1918  
 U. S. Department of Agriculture  
 FOREST SERVICE

C.L.  
 P. J-5

Chippewa NATIONAL FOREST

CORNERS OF THE PUBLIC SURVEY

T. 143N R. 28W 5 PM Mer.

Section Corner common to Sections  
7, 8, 18, and 17

Corner consists of a Cast Iron post in place  
 State condition Good

Dimensions above ground 12" inches  
 Sketch grooves, letters, figures, or notches, on proper face or edge.

CARDINAL POSITION

DIAGONAL POSITION

N	W	S	E	NW	SW	SE	NE

*U.S. General Land Office*  
*Sec 7* *Sec 18* *Sec 17* *Sec 8*  
*143N* *28W*

Mound of \_\_\_\_\_ is located \_\_\_\_\_

Pits are located \_\_\_\_\_

Sketch markings of Bearing Trees (or Rocks) in proper box and fill blanks below, giving bearings from Corner to Trees and Distances in Links.

*No B T's*

Species \_\_\_\_\_  
 Diameter \_\_\_\_\_  
 Bearing \_\_\_\_\_  
 Distance \_\_\_\_\_

Do you believe this to be a genuine Land Office Corner? Yes

If not, why? \_\_\_\_\_

Robert Beveler  
 (Signature)  
3/27/35  
 (Date)  
Collector  
 (Title)

UNITED STATES GEOLOGICAL SURVEY

Corner again  
Picketing N from

Give any further facts which will aid in finding this  
~~chain's direction.~~  
front which this corner bears  
side of  
2 inches diameter, on the  
Metal Location Poster is on a  
Inches 5

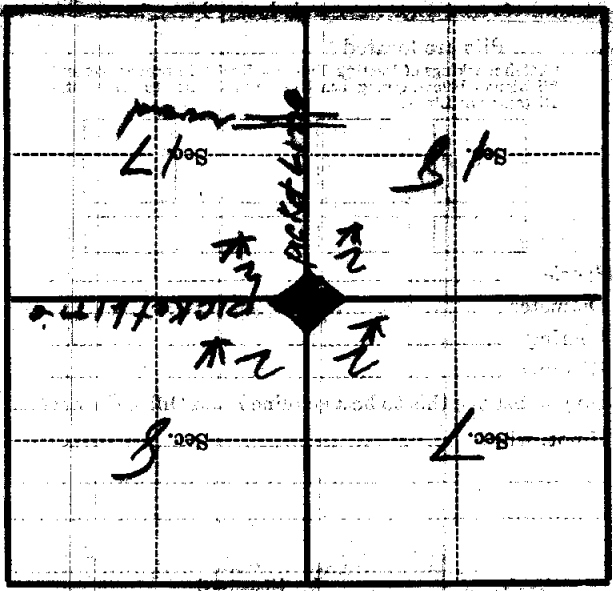

(Make sketch of topography near Corner)

T. 143. N. R. 28. W. S. 31. Mer. T-5