

Form 874-B—Revised May, 1918
U. S. Department of Agriculture
FOREST SERVICE

P. 1

Chippewa NATIONAL FOREST

CORNERS OF THE PUBLIC SURVEY N-3

T. *143 N* R. *28 W* S Mer.

Corner common to Sections *18*, *19*, and

Corner consists of a *Government* (not) in place
State condition *Good*

Dimensions above ground *10* inches
Sketch grooves, letters, figures, or notches, on proper face or edge.

CARDINAL POSITION

DIAGONAL POSITION

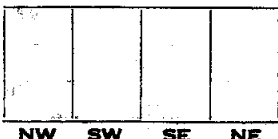
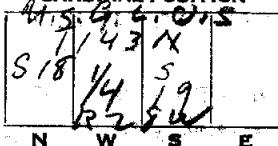

Mound of _____ is located _____

Pits are located _____

Sketch markings of Bearing Trees (or Rocks) in proper box and fill blanks below, giving bearings from Corner to Trees and Distances in Links.

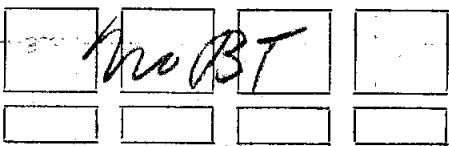

Species _____
Diameter _____
Bearing _____
Distance _____

Do you believe this to be a genuine Land Office Corner? *Yes*
If not, why? _____

Robert Purdee
4/6/35
(Date) *Estimate* (Title)

Corner again.

Give any further facts which will aid in finding this

~~observed distinctly.~~

from which this corner bears

side of

tree 2 inches diameter, on the

Metal Location Poster is on a

Station

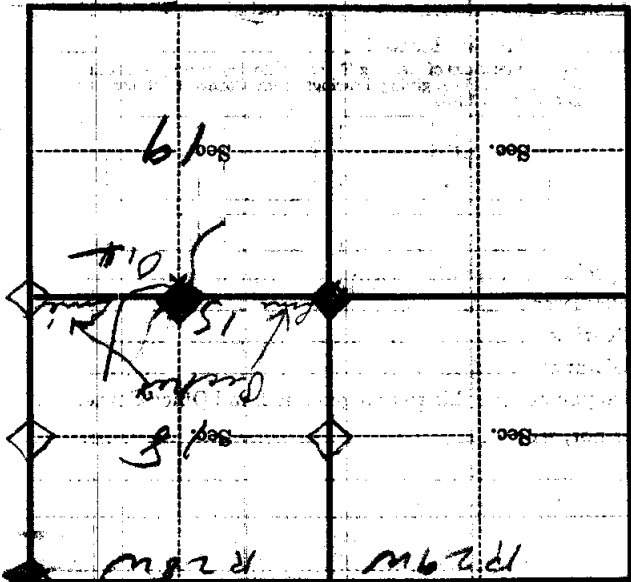

(Make sketch of topography near Corner)

T. 143 N R. 29 W

Mer. N-3