

Z-21

U. S. Department of Agriculture

FOREST SERVICE

Z-21

CHIPPEWA

NATIONAL FOREST

CORNERS OF THE PUBLIC SURVEY

T. 143 N R. 27 W 5 Mer.

Section Corner common to Sections

(35), (36), 2, and 1 squared post

Corner consists of a (not) in place

State condition badly rotted

Dimensions above ground 2 1/2 inches

Sketch grooves, letters, figures, or notches, on proper face or edge.

CARDINAL POSITION

DIAGONAL POSITION

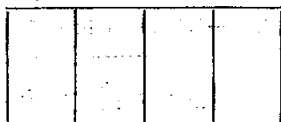

N W S E

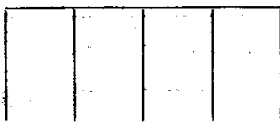

NW SW SE NE

Mound of is located

Pits are located

Sketch markings of Bearing Trees (or Rocks) in proper box and fill blanks below, giving bearings from Corner to Trees and Distances in Links.

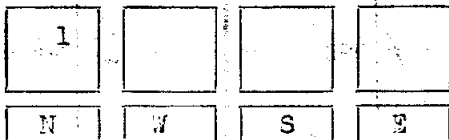

Species Basswood

Diameter 4 1/2"

Bearing N 10° W

Distance 0.88 Chains

Do you believe this to be a genuine Land Office Corner?

If not, why? Co.

Ben E. Lyons

(Signature)

8-11-39

(Date)

Assistant Leader

(Title)

Z-21

5-51

Corner is on the edge of clearing to the southwest and aspen on the other side

Give any further facts which will aid in finding this

from which this Corner bears N 10° W

side of tree

tree inches diameter, on the North

Metal Location Poster is on a

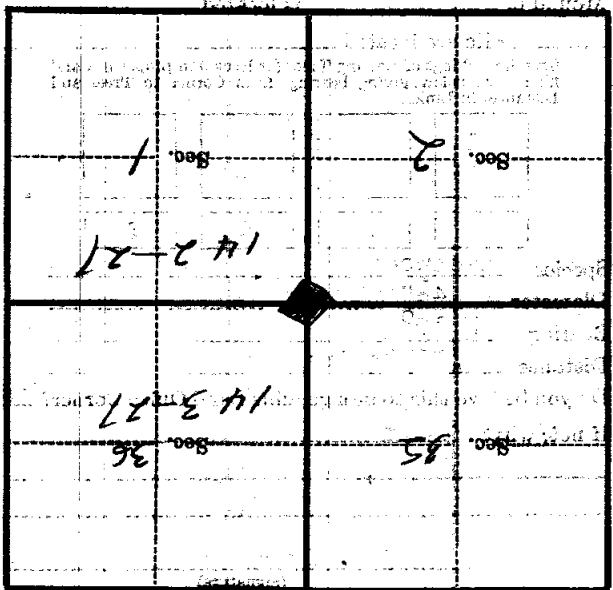

(Make sketch of topography near Corner)