

U. S. Department of Agriculture
FOREST SERVICE

X-9
Posted
12/11/20

X-9

Chippewa NATIONAL FOREST

CORNERS OF THE PUBLIC SURVEY

T. 143 R. 27 5 Mer.

1/4 Corner common to Sections
32, and 33

Corner consists of a post (not) in place
State condition good

Dimensions above ground 40" inches

Sketch grooves, letters, figures, or notches, on proper face or edge.

CARDINAL POSITION

DIAGONAL POSITION

	S		S
	32		33
N	W	S	E

NW	SW	SE	NE

Mound of is located

Pits are located

Sketch markings of Bearing Trees (or Rocks) in proper box and fill blanks below, giving bearings from Corner to Trees and Distances in Links.

Species

Diameter

Bearing

Distance

Do you believe this to be a genuine Land Office Corner? no

If not, why? Genuine Corner

R. Defant
(Signature)

10-30-40
(Date)

J. E.
(Title)

X-9

10 ch. 2 south of Sec 32
set pipe along side post

Corner again.

Give any further facts which will aid in finding this

chains distant. **at corner**

from which this Corner bears

side of

tree..... inches diameter, on the **post**

Metal Location Poster is on a

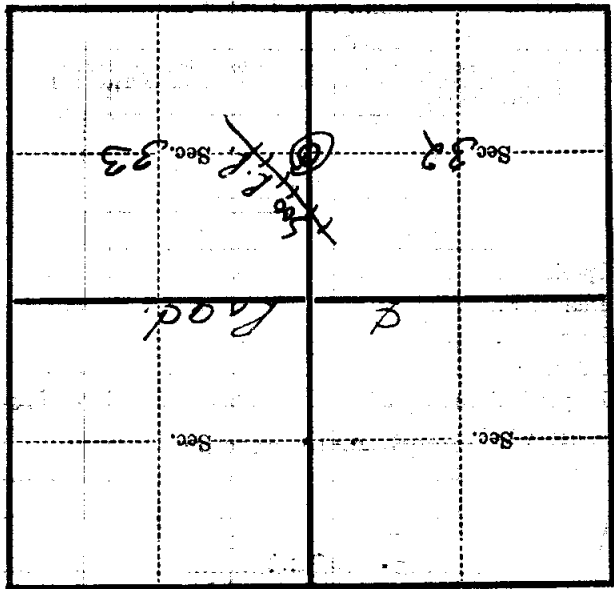

Make sketch of topography near Corner

X-19
NIGHT

R

T