

U. S. Department of Agriculture

FOREST SERVICE

7143-12  
A3

Chippawa NATIONAL FOREST

CORNERS OF THE PUBLIC SURVEY

T. 143 & 144 R. 25-26 5<sup>th</sup> Mer.

Sec. Corner common to Sections 36, 31, 1, and 6

Corner consists of a cedar post (set) in place State condition good.

Dimensions above ground 30 inches

Sketch grooves, letters, figures, or notches, on proper face or edge.

CARDINAL POSITION

DIAGONAL POSITION

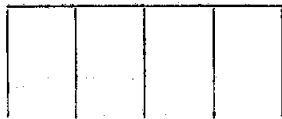

Mound of \_\_\_\_\_ is located \_\_\_\_\_

Pits are located \_\_\_\_\_

Sketch markings of Bearing Trees (or Rocks) in proper box and fill blanks below, giving bearings from Corner to Trees and Distances in Links.

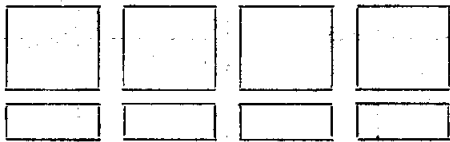

Species \_\_\_\_\_

Diameter \_\_\_\_\_

Bearing \_\_\_\_\_

Distance \_\_\_\_\_

Do you believe this to be a genuine Land Office Corner? *yes*

If not, why? \_\_\_\_\_

*M. J. Shaw*

(Signature)

Engineer

(Title)

Mar 7

(Date)

Corner again.

Give any further facts which will aid in finding this

150 chains distant.

from which this Corner bears East

side of Road

tree inches diameter, on the west

Metal Location Poster is on a fence post.

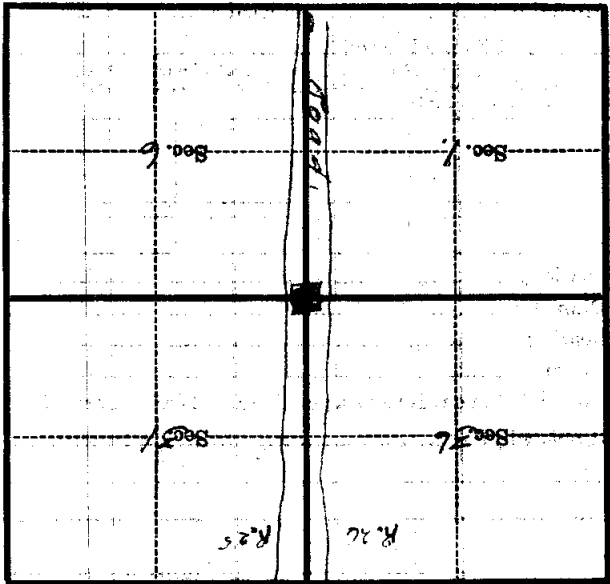

(Make sketch of topography near Corner)

T. 19 N.

R. 25 W.

5th

Mer. N-25