

Form 874-9--Revised May, 1918  
U. S. Department of Agriculture  
FOREST SERVICE

CHIPPewa NATIONAL FOREST

2-21

CORNERS OF THE PUBLIC SURVEY

T. 143 R. 26 5 Mer.

Sec.

36, 35, 2, and 1 Corner common to Sections

Corner consists of a pipe (not) in place

State condition good

Dimensions above ground 12" inches

Sketch grooves, letters, figures, or notches, on proper face or edge.

CARDINAL POSITION

DIAGONAL POSITION

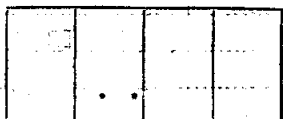
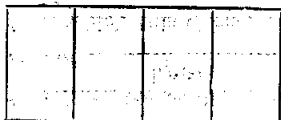

N W S E

NW SW SE NE

Mound of \_\_\_\_\_ is located \_\_\_\_\_

Pits are located \_\_\_\_\_

Sketch markings of Bearing Trees (or Rocks) in proper box and fill blanks below, giving bearings from Corner to Trees and Distances in Links.

Species \_\_\_\_\_

Diameter \_\_\_\_\_

Bearing \_\_\_\_\_

Distance \_\_\_\_\_

Do you believe this to be a genuine Land Office Corner? No

If not, why? John Jelhoug

R. Delant

(Signature)

J. E.

(Title)

7-2-40

(Date)

SECTION  
 T. 143 N. R. 26 E. S. 5 Mer.  
 143  
 26  
 5

Corner again.

Give any further facts which will aid in finding the

chains distant.

81

from which this Corner bears

S 31 W

side of

tree

tree 8 inches diameter, on the

S.W.

Metal Location Poster is on a

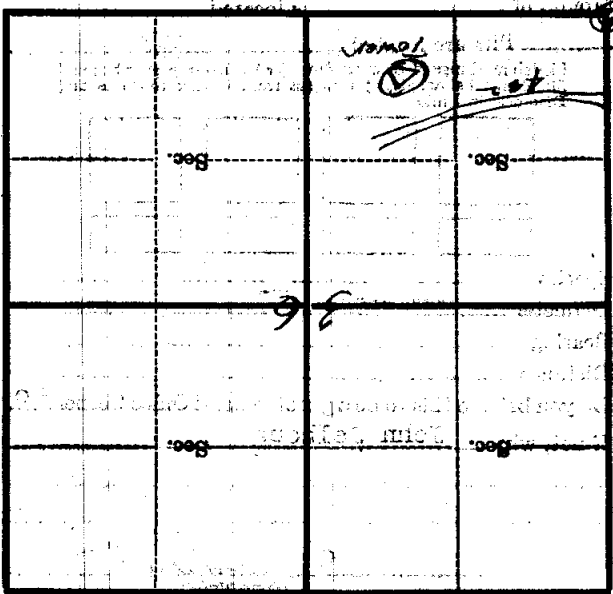

(Make sketch of topography near Corner)