

U. S. Department of Agriculture  
FOREST SERVICE

V23

CHIPPewa NATIONAL FOREST

## CORNERS OF THE PUBLIC SURVEY

T. 143<sup>m</sup> R. 25 5 Mer.N  $\frac{1}{4}$ 

Corner common to Sections



36

Corner consists of a stake ~~corner~~ in placeState condition Cedar Stake FairDimensions above ground 36 inches

Sketch grooves, letters, figures, or notches, on proper face or edge.

CARDINAL POSITION

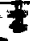
DIAGONAL POSITION

			
Sec.	Sec.		
25	36		
N	W	S	E

NW	SW	SE	NE

Mound of \_\_\_\_\_ is located \_\_\_\_\_

Pits are located \_\_\_\_\_

Sketch markings of Bearing Trees (or Rocks) in proper box and fill blanks below, giving bearings from Corner to Trees and Distances in Links.

 S-36			
B.T.			

Species MapleDiameter 10"Bearing S 40° EDistance 9Do you believe this to be a genuine Land Office Corner? Yes

If not, why? \_\_\_\_\_

RAYMOND T. DEFANT

(Signature)

Jr. Civil Engineer

(Title)

3-11-40

(Date)

Metal Location Poster is on a Bearing Line  
 two 10 inch diameter, on the N.W. side of  
 from which this Corner bears N 40° W  
 Give any further facts which will aid in finding this  
 Corner again.  
 Blazed line approx. 25 links South  
 of corner.

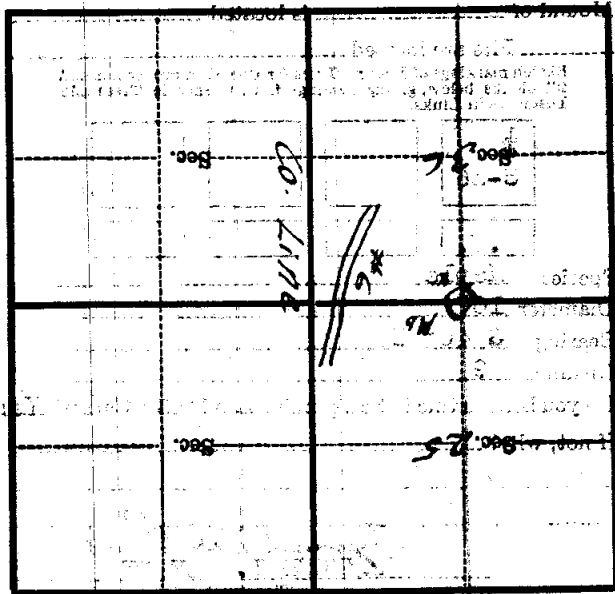

(Make sketch of topography near Corner)

Form 874-9—Revised May, 1918  
U. S. Department of Agriculture  
FOREST SERVICE

V-23

CHIPPWA NATIONAL FOREST

CORNERS OF THE PUBLIC SURVEY

T. 145<sup>m</sup> R. 25 S. Mer.

N 1/2

Corner common to Sections

36

Corner consists of a stake ~~mark~~ in place

State condition Cedar Stake Fair

Dimensions above ground 36 inches

Sketch grooves, letters, figures, or notches, on proper face or edge.

CARDINAL POSITION

DIAGONAL POSITION

1 Sec. 25		2 Sec. 36	
N	W	S	E

NW	SW	SE	NE

Mound of \_\_\_\_\_ is located \_\_\_\_\_

Pits are located \_\_\_\_\_

Sketch markings of Bearing Trees (or Rocks) in proper box and fill blanks below, giving bearings from Corner to Trees and Distances in Links.

1 S-36			
B.T.			

Species Maple

Diameter 10"

Bearing S 40° E

Distance 9

Do you believe this to be a genuine Land Office Corner? Yes

If not, why? \_\_\_\_\_

*Raymond T. DeFaut*  
RAYMOND T. DEFAUT

(Signature)

Jr. Civil Engineer

(Title)

3-11-40

(Date)

