

Form 874-9—Revised May, 1918  
U. S. Department of Agriculture  
FOREST SERVICE

8  
V7

CHIPPENAW NATIONAL FOREST

CORNERS OF THE PUBLIC SURVEY

T. 143 R. 25 S. 5 Mer.

1/4 Corner common to Sections  
29, and 32

Corner consists of a stake (not) in place

State condition fair

Dimensions above ground 20" inches

Sketch grooves, letters, figures, or notches, on proper face or edge.

CARDINAL POSITION

DIAGONAL POSITION

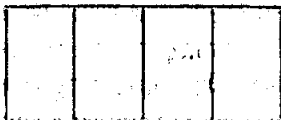

N W S E

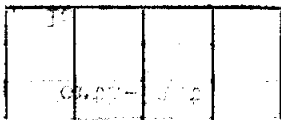

NW SW SE NE

Mound of \_\_\_\_\_ is located \_\_\_\_\_

Pits are located \_\_\_\_\_

Sketch markings of Bearing Trees (or Rocks) in proper box and fill blanks below, giving bearings from Corner to Trees and Distances in Links.



Species \_\_\_\_\_

Diameter \_\_\_\_\_

Bearing \_\_\_\_\_

Distance \_\_\_\_\_

Do you believe this to be a genuine Land Office Corner? No

If not, why? Co. Corner

*R. Defaut*  
(Signature)  
*J. E.*  
(Title)

6-28-40  
(Date)

Blake covered over

Ash may be HT

Corner again.

Give any further facts which will aid in finding this

chains distant.

27

from which this Corner bears N 15 E

side of trees

tree 8 inches diameter, on the North-East

Metal Location Poster is on a Ash

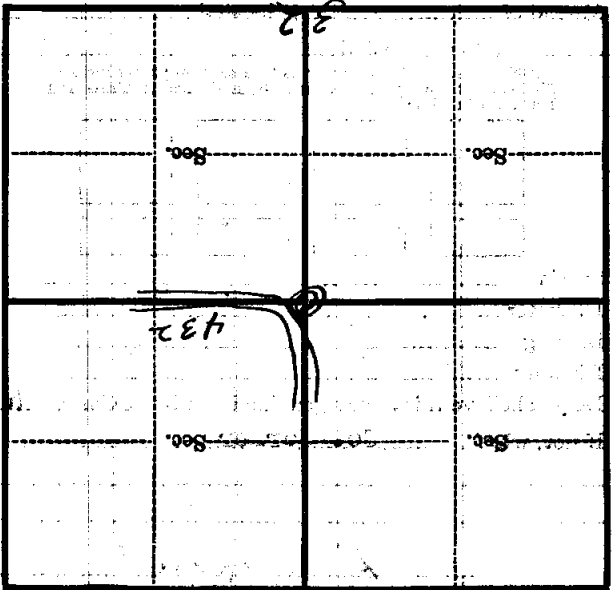

(Make sketch of topography near Corner)

T. 143

R. 25

S. 5

Mer.

V-73

Form 874-9—Revised May, 1918  
U. S. Department of Agriculture  
FOREST SERVICE

P  
V-7

~~CHIPPWA~~ NATIONAL FOREST  
CORNERS OF THE PUBLIC SURVEY

T. 148 R. 25 Mer.

Corner common to Sections  
29, and 32

Corner consists of a stake (not) in place

State condition fair

Dimensions above ground 30" inches

Sketch grooves, letters, figures, or notches, on proper face or edge.

CARDINAL POSITION

DIAGONAL POSITION

--	--	--	--

N W S E

--	--	--	--

NW SW SE NE

Mound of \_\_\_\_\_ is located \_\_\_\_\_

Pits are located \_\_\_\_\_

Sketch markings of Bearing Trees (or Rocks) in proper box and fill blanks below, giving bearings from Corner to Trees and Distances in Links.

Species \_\_\_\_\_

Diameter \_\_\_\_\_

Bearing \_\_\_\_\_

Distance \_\_\_\_\_

Do you believe this to be a genuine Land Office Corner? Ma

If not, why? Co. Corner

*R. Defant*

(Signature)

*J. E.*

(Title)

6-22-19

(Date)

These corners are

not to be

Corner again.

Give any further facts which will aid in finding this

chains distant.

from which this Corner bears

side of

tree inches diameter, on the

Metal Location Poster is on a

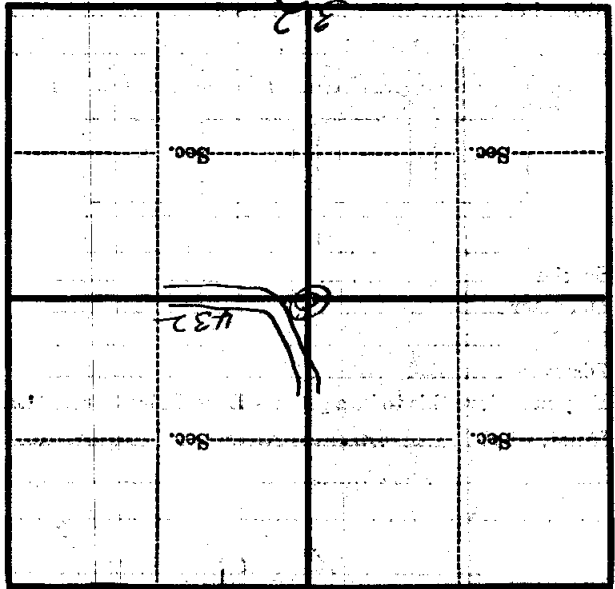

(Make sketch of topography near Corner)