

U. S. Department of Agriculture  
FOREST SERVICE

*Chippewa* NATIONAL FOREST

CORNERS OF THE PUBLIC SURVEY

T. *142 N.* R. *31 W.* *5<sup>th</sup>* Mer.

*Section* Corner common to Sections

*4, 5, 8, and 9*

Corner consists of a *iron pipe* in place

State condition *fair*

Dimensions above ground *2 1/2 x 3 1/2* inches

Sketch grooves, letters, figures, or notches, on proper face or edge.

CARDINAL POSITION

DIAGONAL POSITION

<i>None</i>			
N	W	S	E

NW	SW	SE	NE

Mound of \_\_\_\_\_ is located \_\_\_\_\_

Pits are located \_\_\_\_\_

Sketch markings of Bearing Trees (or Rocks) in proper box and fill blanks below, giving bearings from Corner to Trees and Distances in Links.

<i>1</i>			

Species *None*

Diameter \_\_\_\_\_

Bearing \_\_\_\_\_

Distance \_\_\_\_\_

Do you believe this to be a genuine Land Office Corner? \_\_\_\_\_

If not, why? \_\_\_\_\_

*Co. Resurvey corner*

*Dorman J. Sutton*

(Signature)

*Engineer*

(Title)

*3-16-35*

(Date)

Corner again.  
W. of U.S. Highway No. 371  
H. 50 chains in swamp

Metal Location Poster is on a *Nine* inches diameter, on the side of from which this Corner bears chains distant. Give any further facts which will aid in finding this

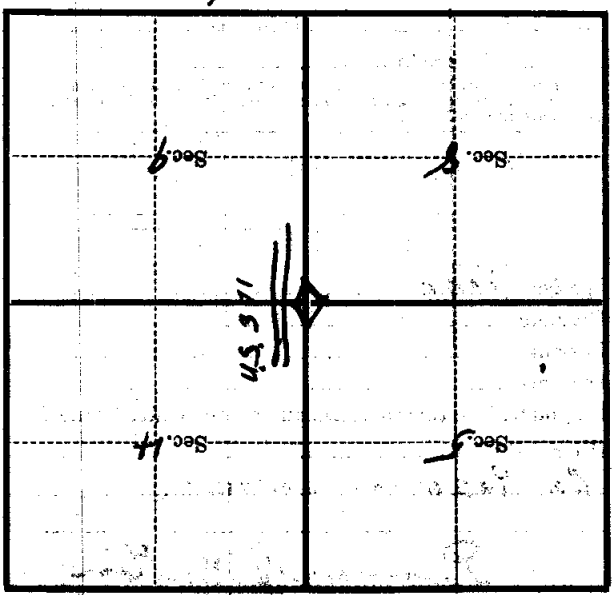

(Make sketch of topography near Corner)

T. 12 N. R. 31 W. 5th Mer. E-9