

U. S. Department of Agriculture
FOREST SERVICE

A-1

Chippewa NATIONAL FOREST

CORNERS OF THE PUBLIC SURVEY

T. 142 N R. 31 W 5th Mer.

1/4 Corner common to Sections 5, and 32 - T143N-R31W

Corner consists of a 1" I.M. & brass cap in place

State condition good

Dimensions above ground 4 inches

Sketch grooves, letters, figures, or notches, on proper face or edge.

CARDINAL POSITION

DIAGONAL POSITION

| | | | |
|--|--|--|--|
| | | | |
|--|--|--|--|

N W S E

| | | | |
|--|--|--|--|
| | | | |
|--|--|--|--|

NW SW SE NE

Mound of _____ is located _____

Pits are located _____

Sketch markings of Bearing Trees (or Rocks) in proper box and fill blanks below, giving bearings from Corner to Trees and Distances in Links.

| |
|--|
| 165 150 120 1 1/4 120 150 165 |
|--|

| |
|---------------|
| GROWN OVER |
|---------------|

| |
|--|
| |
|--|

| |
|--|
| |
|--|

| |
|------|
| B.T. |
|------|

| |
|--|
| |
|--|

| |
|--|
| |
|--|

| |
|--|
| |
|--|

Species W. Pine W. Oak

Diameter 16" 8"

Bearing S35°E N14°E

Distance 71 lks. 97 lks.

Do you believe this to be a genuine Land Office Corner? yes

If not, why? _____

Arthur T. Johnson
Arthur T. Johnson
(Signature)

Project Ass't
(Title)

11/3/38
(Date)

640

A line runs E & W thru this corner.
 2 lks. N. of G.L.O. cap is a 2" I.M. &
 cap which is on record as set by county
 surveyor in 1915.

Corner again.

Give any further facts which will aid in finding this
 chains distant.

from which this Corner bears

side of

tree inches diameter, on the

Metal Location Poster is on a

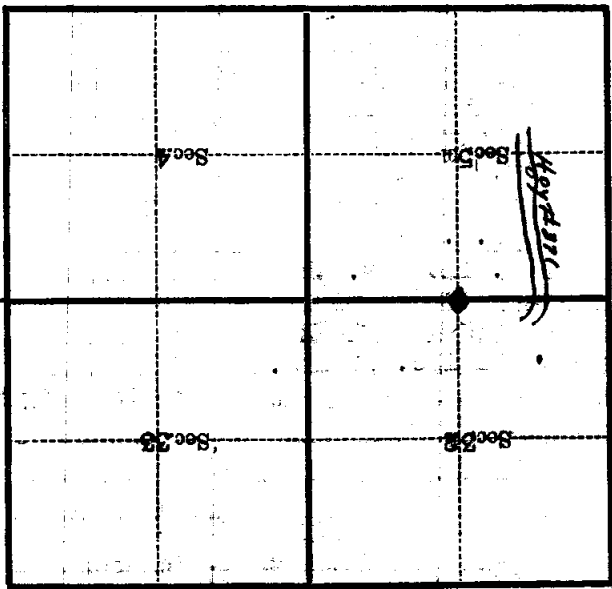

(Make sketch of topography near Corner)

T. 142 N. R. 31 W. 5th Mer.

A-7