

U. S. Department of Agriculture
FOREST SERVICE

T-11, 12

Chippewa NATIONAL FOREST
CORNERS OF THE PUBLIC SURVEY

T. *142 N* R. *30 W* *5* Mer.

164 Corner common to Sections
28, located 10.03 N. of C. & 1/16 corner

Corner consists of a *1" I.P. w/ cap* (not) in place
State condition *Good*

Dimensions above ground *6* inches

Sketch grooves, letters, figures, or notches, on proper face or edge.

CARDINAL POSITION

DIAGONAL POSITION

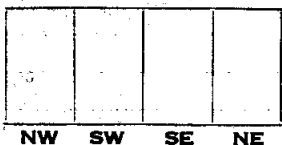
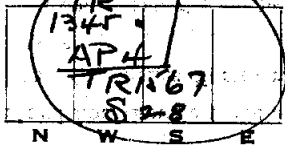

Mound of _____ is located _____

Pits are located _____

Sketch markings of Bearing Trees (or Rocks) in proper box and fill blanks below, giving bearings from Corner to Trees and Distances in Links.

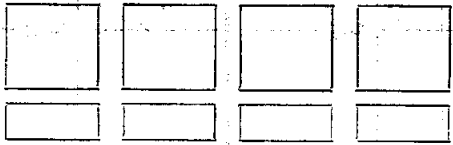

Species _____

Diameter _____

Bearing _____

Distance _____

Do you believe this to be a genuine Land Office Corner? *Yes*

If not, why? _____

1/13/37
(Date)

R. Moorey, Asst. Dir. - F & S
(Signature)
(Title)

Corner again.

Give any further facts which will aid in finding this

0.14 chains distant.

from which this Corner bears

S 47 E

side of

tree 10 inches diameter, on the

Metal Location Poster is on a

Corner

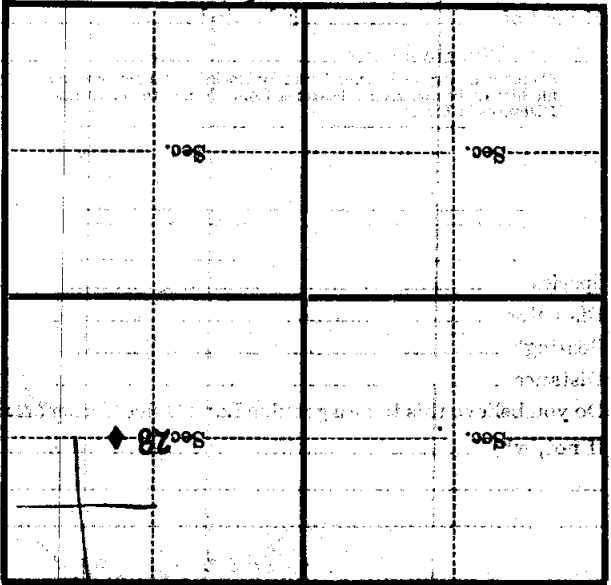

(Make sketch of topography near Corner)

T. 142N R. 30W

64

Nov. 11, 1912