

U. S. Department of Agriculture
FOREST SERVICE

Q-8

Chippewa

NATIONAL FOREST

CORNERS OF THE PUBLIC SURVEY

T. *14 2 N* R. *30 W* Mer. *5 2*

SE 1/16

Corner common to Sections

20

and

Corner consists of a *1" I.P.W/cap* (not) in place

State condition *Good*

Dimensions above ground *4* inches

Sketch grooves, letters, figures, or notches, on proper face or edge.

CARDINAL POSITION

DIAGONAL POSITION

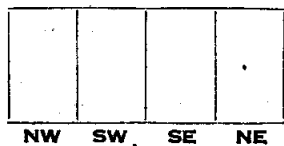
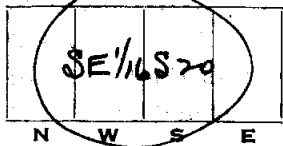

Mound of _____ is located _____

Pits are located _____

Sketch markings of Bearing Trees (or Rocks) in proper box and fill blanks below, giving bearings from Corner to Trees and Distances in Links.

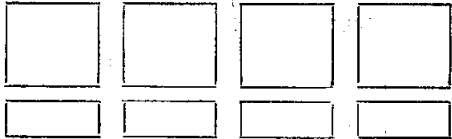

Species _____

Diameter _____

Bearing _____

Distance _____

Do you believe this to be a genuine Land Office Corner? *Yes*

If not, why? _____

2/2/37
(Date)

R. Moore
(Signature)
Asst. Ldr. - F 48
(Title)

Corner again.

Give any further facts which will aid in finding this

0.10 chains distant.

from which this Corner bears *0.51 E*

side of

tree *4* inches diameter, on the

Copied Metal Location Poster is on a

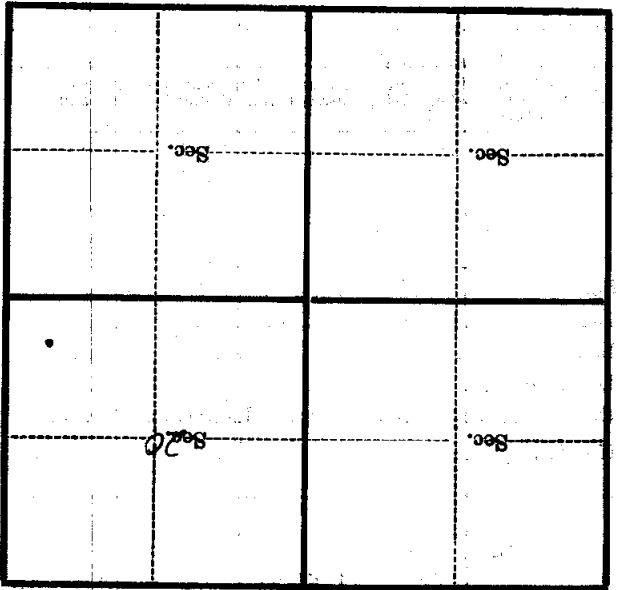

(Make sketch of topography near Corner)