

U. S. Department of Agriculture
FOREST SERVICE

V-12

Chippewa NATIONAL FOREST

CORNERS OF THE PUBLIC SURVEY

T. *142N* R. *30W* *500* Mer.

E 1/16 Corner common to Sections
28, and *33*

Corner consists of a *4" Aspen post* (not) in place
State condition *Good*

Dimensions above ground *36* inches

Sketch grooves, letters, figures, or notches, on proper face or edge.

CARDINAL POSITION

DIAGONAL POSITION

N	W	S	E

NW	SW	SE	NE

Mound of _____ is located _____

Pits are located _____

Sketch markings of Bearing Trees (or Rocks) in proper box and fill blanks below, giving bearings from Corner to Trees and Distances in Links.

Species _____

Diameter *None* _____

Bearing *None* _____

Distance _____

Do you believe this to be a genuine Land Office Corner? *No*

If not, why?

Established by CCC crew

1/11/37
(Date)

R. Moore
(Signature)
Asst. Dir. FHS
(Title)

Corner again.

Give any further facts which will aid in finding this

chain's distant.

from which this Corner bears *N 62 W* side of

tree inches diameter, on the

Metal Location Poster is on a *Corner*

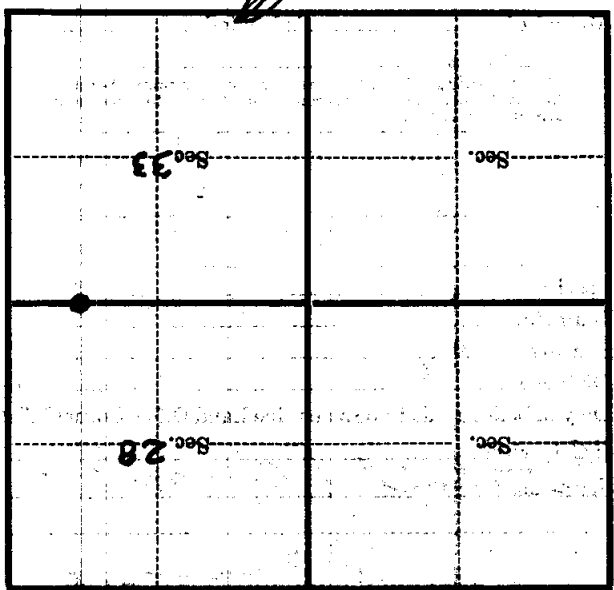

(Make sketch of topography near Corner)

T. 142 N R. 30 W
5th Mer. V-12

178
9-28-37
C.C.C.

U. S. Department of Agriculture
FOREST SERVICE

Chippewa NATIONAL FOREST

CORNERS OF THE PUBLIC SURVEY

T. *147N* R. *30W* *5th* Mer.

E 1/16 Corner common to Sections
28, and *33*

Corner consists of a *4" aspen post* (not) in place
State condition *Good*

Dimensions above ground *36* inches

Sketch grooves, letters, figures, or notches, on proper face or edge.

CARDINAL POSITION

DIAGONAL POSITION

N W S E

NW SW SE NE

Mound of _____ is located _____

Pits are located _____

Sketch markings of Bearing Trees (or Rocks) in proper box and fill blanks below, giving bearings from Corner to Trees and Distances in Links.

Species _____

Diameter *3* _____

Bearing *True* _____

Distance _____

Do you believe this to be a genuine Land Office Corner? *No*

If not, why? _____

Established by C.C.C. crew

P. Moore

(Signature)

Asst. Dir. - F.A.

(Title)

1/11/37
(Date)

U. S. DEPARTMENT OF AGRICULTURE

COMMISSION ON THE PUBLIC SURVEY

Corner again.

Give any further facts which will aid in finding this

chain distant.

from which this corner bears *N 62° W*

side of

tree 6 inches diameter, on the

Metal Location Poster is on a *beam*

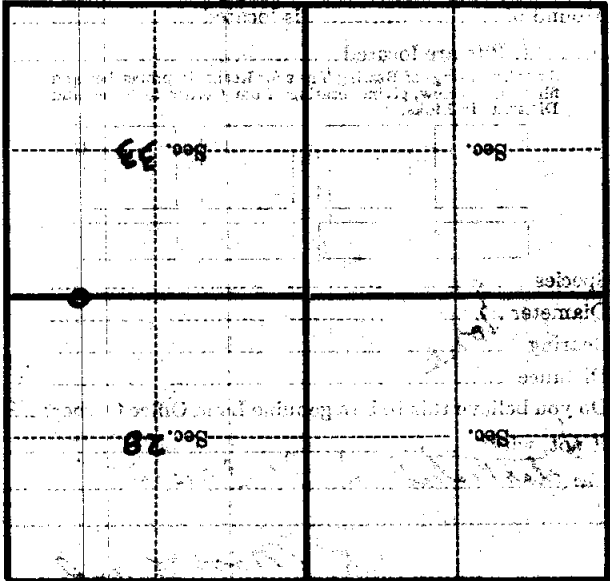

(Make sketch of topography near corner)

1-12
MGT.

T 14° N R 30 W