

U. S. Department of Agriculture  
FOREST SERVICE

*Chippewa*

NATIONAL FOREST

CORNERS OF THE PUBLIC SURVEY

T. *142N* R. *30W* *5th* Mer.

Corner common to Sections

*28, 29, 32, and 33*

Corner consists of a *3 aspen post* (not) in place

State condition *Good*

Dimensions above ground *36* inches

Sketch grooves, letters, figures, or notches, on proper face or edge.

CARDINAL POSITION

DIAGONAL POSITION

N	W	S	E

NW	SW	SE	NE

Mound of \_\_\_\_\_ is located \_\_\_\_\_

Pits are located \_\_\_\_\_

Sketch markings of Bearing Trees (or Rocks) in proper box and fill blanks below, giving bearings from Corner to Trees and Distances in Links.

Species \_\_\_\_\_

Diameter \_\_\_\_\_

Bearing \_\_\_\_\_

Distance \_\_\_\_\_

Do you believe this to be a genuine Land Office Corner? *No*

If not, why? *The post is at edge of road. The L.O. has been destroyed in road construction.*

*R. Moore*

(Signature)

*1/15/37*  
(Date)

*Road - FH8*  
(Title)

Corner again.  
N. E. Section at 161 also  
N. of corner corner post.

Give any further facts which will aid in finding this  
chain distant.

from which this Corner bears  
side of  
tree inches diameter, on the  
Metal Location Post is on *at foot of way*

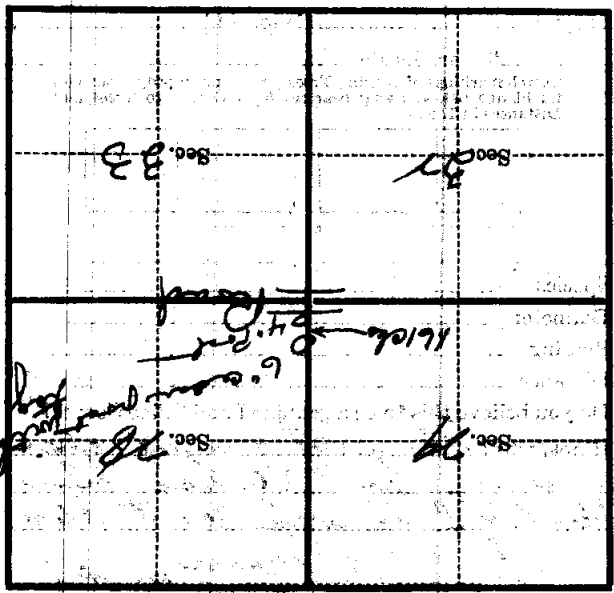

(Make sketch of topography near Corner)