

Form 874-9—Revised May, 1918  
U. S. Department of Agriculture  
FOREST SERVICE

P.

Chippewa NATIONAL FOREST

Q-R5

CORNERS OF THE PUBLIC SURVEY

T. 142N R. 27W 5P Mer.

MC

Corner common to Sections

19, 20

and

Corner consists of a ~~Govt Iron Post~~ in place

State condition Good

Dimensions above ground 14" inches

Sketch grooves, letters, figures, or notches, on proper face or edge.

CARDINAL POSITION

DIAGONAL POSITION

U.S.G.L.O. Survey  
T. 142 N R. 27 W  
S. 19 MC S. 20

|  |  |  |  |
|--|--|--|--|
|  |  |  |  |
|--|--|--|--|

|  |  |  |  |
|--|--|--|--|
|  |  |  |  |
|--|--|--|--|

N W S E

NW SW SE NE

Mound of \_\_\_\_\_ is located \_\_\_\_\_

Pits are located \_\_\_\_\_

Sketch markings of Bearing Trees (or Rocks) in proper box and fill blanks below, giving bearings from Corner to Trees and Distances in Links.

|  |  |  |  |
|--|--|--|--|
|  |  |  |  |
|  |  |  |  |

Species \_\_\_\_\_

Diameter \_\_\_\_\_

Bearing \_\_\_\_\_

Distance \_\_\_\_\_

Do you believe this to be a genuine Land Office Corner? **Yes**

If not, why? \_\_\_\_\_

Robert Penick

(Signature)

Estimator

(Title)

4/2/31  
(Date)

MC Broom  
on line  
19-30, 8 50W  
Apr. 4  
five post

Corner again

Give any further facts which will aid in finding this

chains distant.

from which this corner bears

side of

two inches diameter, on the

Metal Location Poster is on a

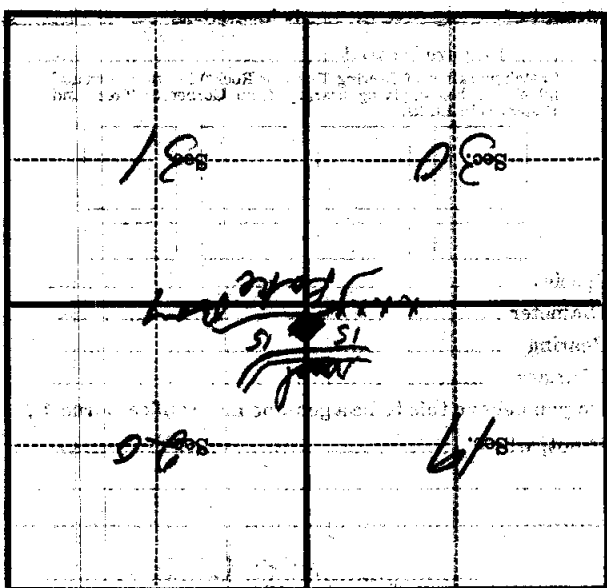

(Make sketch of topography near Corner)

T. L. W. R. 27W 5-P Mer. Q-R-5

Form 874-a—Revised May, 1918  
U. S. Department of Agriculture  
FOREST SERVICE

925

CHIPPEWA NATIONAL FOREST

CORNERS OF THE PUBLIC SURVEY

T. 142 N R. 27W 5th. Mer.  
M.C. Corner common to Sections

19, 20, and

Corner consists of a Gov't iron post in place

State condition good

Dimensions above ground 14" inches

Sketch-grooves, letters, figures, or notches, on proper face or edge.

CARDINAL POSITION

DIAGONAL POSITION

|               |      |      |   |
|---------------|------|------|---|
| US GEO SURVEY |      |      |   |
| T142N         |      | R27W |   |
| S19           | M.C. | S20  |   |
| N             | W    | S    | E |

|    |    |    |    |
|----|----|----|----|
|    |    |    |    |
|    |    |    |    |
| NW | SW | SE | NE |

Mound of is located

Pits are located

Sketch markings of Bearing Trees (or Rocks) in proper box and fill blanks below, giving bearings from Corner to Trees and Distances in Links.

|  |  |  |  |
|--|--|--|--|
|  |  |  |  |
|  |  |  |  |

Species

Diameter

Bearing

Distance

Do you believe this to be a genuine Land Office Corner? Yes

If not, why?

R.P.

(Signature)

Estimator

(Title)

4/2/35

(Date)

2-18

19-30 S. 50° W. apprx. 4 chs. from this post.  
M.C. bearing tree on line between  
Corner again.

Give any further facts which will aid in finding this  
obtain distant  
at corner

side of  
tree 3 inches diameter, on the north  
Metal Location Post is on a spruce stake

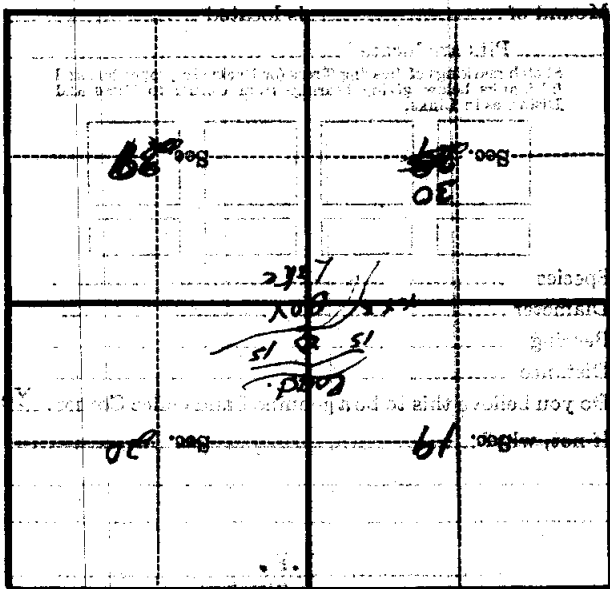

(Make sketch of topography by near Corner)

Mer. 0.R-5