

Form 874-B Revised May, 1918
 U. S. Department of Agriculture
 FOREST SERVICE

V-20

Chippewa NATIONAL FOREST

CORNERS OF THE PUBLIC SURVEY

T. 142 R. 27 5 Mer.

#15 - 1/16 Corner common to Sections
26, and 26

Corner consists of a post (553) in place
 State condition good

Dimensions above ground 23" inches

Sketch grooves, letters, figures, or notches, on proper face or edge.

CARDINAL POSITION

DIAGONAL POSITION

1/16		1/16	
S		S	
26		35	
N	W	S	E

NW	SW	SE	NE

Mound of _____ is located _____

Pits are located _____

Sketch markings of Bearing Trees (or Rocks) in proper box and fill blanks below, giving bearings from Corner to Trees and Distances in Links.

1/16	1/16		
S 26	S 35		

Species Cedar Pine Log
 Diameter 8" 10"
 Bearing N82° E S23W
 Distance 10 19

Do you believe this to be a genuine Land Office Corner? No
 If not, why? County Corner

Raymond T. Defant
 (Signature)
Fr. Civil Engineer
 (Title)

10/17/40
 (Date)

Model Location Poster is on a _____ inches diameter, on the _____ side of _____ from which this Corner bears _____ chartis distant. Give any further facts which will aid in finding the _____ Comes again.

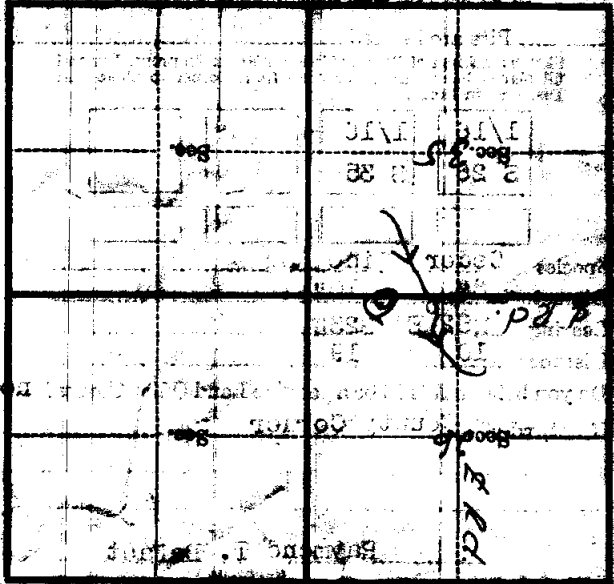

(Place sketch of _____ in _____)

Form 974-D—Revised May, 1918
U. S. Department of Agriculture
FOREST SERVICE

22
V20

Chippewa NATIONAL FOREST

CORNERS OF THE PUBLIC SURVEY

T. 142 R. 27 S. 5 Mer.

#15- 1/16 Corner common to Sections

_____, _____, 26, and _____

Corner consists of a Cedar post (not) in place

State condition Fair

Dimensions above ground fair inches

Sketch grooves, letters, figures, or notches, on proper face or edge.

CARDINAL POSITION

DIAGONAL POSITION

S		S	
26		35	

N W S E

NW SW SE NE

Mound of _____ is located _____

Pits are located _____

Sketch markings of Bearing Trees (or Rocks) in proper box and fill blanks below, giving bearings from Corner to Trees and Distances in Links.

Species cedar pine

Diameter 6" 10"

Bearing N82° E S23° W

Distance 0.10 0.109

Do you believe this to be a genuine Land Office Corner? no

If not, why? County Corner

R. T. Defant
Raymond T. Defant
(Signature)

3/16/40
(Date)

Jr. Civil Engineer
(Title)

Corner again.

Give any further facts which will aid in finding the

chains distant.

40

from which this Corner bears

S72N

Tree

tree 10 inches diameter, on the S.W.

Metal Location Posters is on a

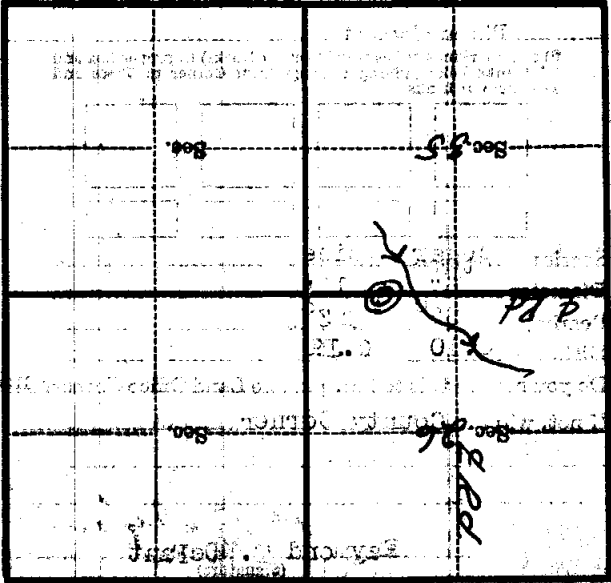

(Make sketch of location of Corner)