

U. S. Department of Agriculture

FOREST SERVICE

P.
V19

Chippewa Purchase NATIONAL FOREST

CORNERS OF THE PUBLIC SURVEY

T. 147 R. 27 S. 12 Mer.

1/4 Corner common to Sections

26, and 35

Corner consists of a Cedar Post (set) in place

State condition Good

Dimensions above ground 24 inches

Sketch grooves, letters, figures, or notches, on proper face or edge.

CARDINAL POSITION

DIAGONAL POSITION

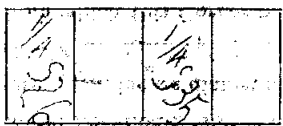

Mound of _____ is located _____

Pits are located _____

Sketch markings of Bearing Trees (or Rocks) in proper box and fill blanks below, giving bearings from Corner to Trees and Distances in Links.



Species _____

Diameter _____

Bearing _____

Distance _____

Do you believe this to be a genuine Land Office Corner? **NO**

If not, why? **County Survey Year 1915**

[Handwritten Signature]

(Signature)

(Date)

(Title)

Corner again
Post located at app.
Intersection of tangents
of Road Due North and
Due West.

Give any further facts which will aid in finding this

chains distant.

3

Metal Location: Post is on a Norway Pine
tree 12 inches diameter, on the West
side of County Road turning North
from which this Corner bears East

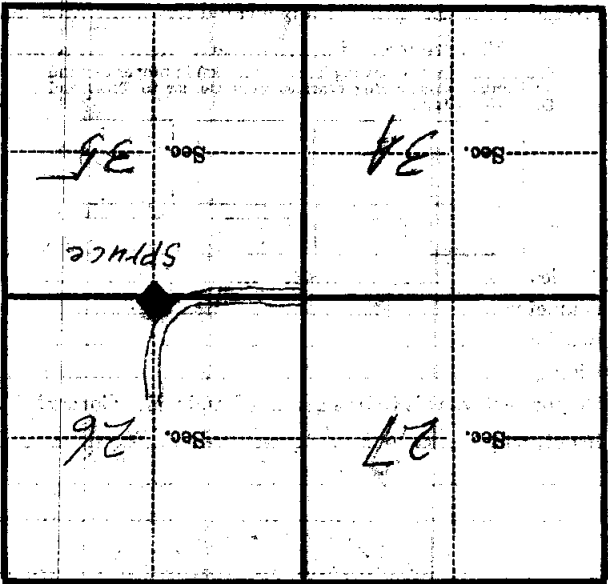

(Make sketch of topography near Corner)

U. S. Department of Agriculture

FOREST SERVICE

CHIPPEWA

NATIONAL FOREST

V-19

CORNERS OF THE PUBLIC SURVEY

T. 142 R. 27W 5th. Mer.

$\frac{1}{4}$ Corner common to Sections
 _____, _____, 26, and ~~25~~ 32

Corner consists of a Cedar Post (cont) in place
 State condition Good

Dimensions above ground 24 inches
 Sketch grooves, letters, figures, or notches, on proper face or edge.

CARDINAL POSITION

DIAGONAL POSITION

$\frac{1}{4}$ S 26		$\frac{1}{4}$ S 35	
N	W	S	E

NW	SW	SE	NE

Mound of _____ is located _____

Pits are located _____

Sketch markings of Bearing Trees (or Rocks) in proper box and
 fill blanks below, giving bearings from Corner to Trees and
 Distances in Links.

Species _____

Diameter _____

Bearing _____

Distance _____

Do you believe this to be a genuine Land Office Corner? No.

If not, why? County Survey

Year 1915

O.G.Q.

(Signature)

Engineer

Mar. 6, 35

(Date)

(Title)

L.W.

12-4-79 G. Peterson Postold
Sketch to be placed

Post located at App. intersection
of tangents of road due North
and due West.
Corner again.

Give any further facts which will aid in finding this
chain distant.

from which this Corner bears
East
side of County Road Turning North
tree 12 inches diameter, on the left
Metal Location Post is on a
Northwest

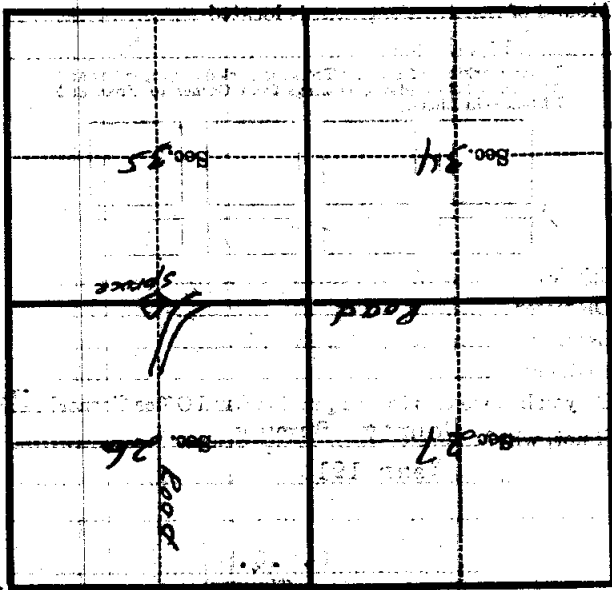

(Name sketch of topography near Corner)

V-19