

Form 874-9—Revised May, 1918  
 U. S. Department of Agriculture  
 FOREST SERVICE

Posted  
 12/1/18  
 L-9

Chippewa NATIONAL FOREST  
 CORNERS OF THE PUBLIC SURVEY

T. 142 R. 26 Mer. 8

1 Corner common to Sections  
16, and 17

Corner consists of a none (not) in place  
 State condition

Dimensions above ground \_\_\_\_\_ inches

Sketch grooves, letters, figures, or notches, on proper face or edge.

CARDINAL POSITION

DIAGONAL POSITION

--	--	--	--

N W S E

--	--	--	--

NW SW SE NE

Mound of \_\_\_\_\_ is located \_\_\_\_\_

Pits are located \_\_\_\_\_

Sketch markings of Bearing Trees (or Rocks) in proper box and fill blanks below, giving bearings from Corner to Trees and Distances in Links.

<u>1</u>			
<u>317</u>			
<u>B. T.</u>			

Species K. P. STP

Diameter 307

Bearing 85 1/2 W

Distance 12

Do you believe this to be a genuine Land Office Corner? Yes

If not, why? \_\_\_\_\_

R. DeForest  
 (Signature)

10-17-40

(Date)

J. R.  
 (Title)

Blind along side of N. E.

Corner again.

Give any further facts which will aid in finding the

chain distant.

Blind

from which this Corner bears

Blind

side of

N. E.

tree inches diameter, on the

Blind

Metal Location Poster is on a

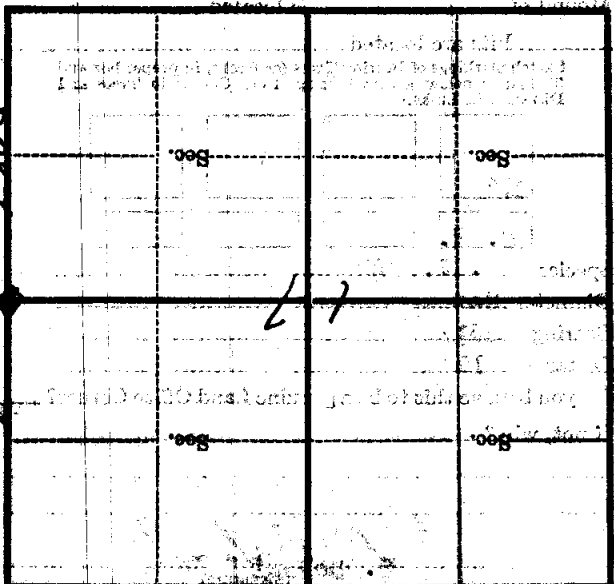

Sketch of topography near Corner

U. S. Department of Agriculture  
FOREST SERVICE

*Posted  
12/11/20*

*L-9*

Chippewa NATIONAL FOREST

CORNERS OF THE PUBLIC SURVEY

T. 142 R. 26 Mer. 5

1/4 Corner common to Sections  
16, and 17.

Corner consists of a none (not) in place

State condition \_\_\_\_\_

Dimensions above ground \_\_\_\_\_ inches

Sketch grooves, letters, figures, or notches, on proper face or edge.

CARDINAL POSITION

DIAGONAL POSITION

--	--	--	--

--	--	--	--

N W S E

NW SW SE NE

Mound of \_\_\_\_\_ is located \_\_\_\_\_

Pits are located \_\_\_\_\_

Sketch markings of Bearing Trees (or Rocks) in proper box and fill blanks below, giving bearings from Corner to Trees and Distances in Links.

1/4			
817			

B. T.			
-------	--	--	--

Species W. P. STP

Diameter 24"

Bearing 551W

Distance 19

Do you believe this to be a genuine Land Office Corner? **yes**

If not, why? \_\_\_\_\_

*R. DeFang*  
Rv DeFang (Signature)

10-17-40

(Date)

J. E.

(Title)

BLANK ALONG SIDE OF R. 1.

Corner again.

Give any further facts which will aid in finding this

chain distant.

BLANK

from which this corner bears

side of

R. 1.

tree inches diameter, on the

RIVER

Metal Location Poster is on a

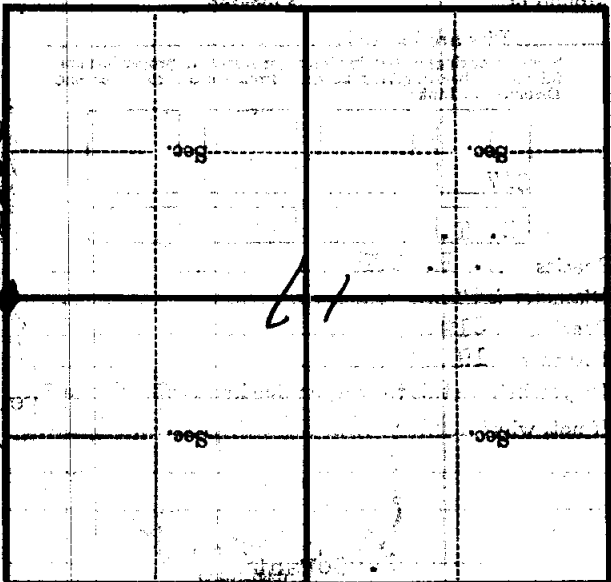

(Make sketch of topography near corner)