

U. S. Department of Agriculture
FOREST SERVICE

J-5

Chippewa NATIONAL FOREST

CORNERS OF THE PUBLIC SURVEY

T. 142 R. 26 5th Mer.

Section Corner common to Sections
7, 8, 18, and 17

Corner consists of a Iron Pipe (set) in place

State condition Good

Dimensions above ground 15 inches

Sketch grooves, letters, figures, or notches, on proper face or edge.

CARDINAL POSITION

DIAGONAL POSITION

--	--	--	--

N W S E

--	--	--	--

NW SW SE NE

Mound of _____ is located _____

Pits are located _____

Sketch markings of Bearing Trees (or Rocks) in proper box and fill blanks below, giving bearings from Corner to Trees and Distances in Links.

Species _____

Diameter _____

Bearing _____

Distance _____

Do you believe this to be a genuine Land Office Corner? No

If not, why? Probably County Survey.

Marked 7, 8, 18, 17.

O. G. G.

(Signature)

Mar 2, 35

(Date)

Engineer

(Title)

(Make sketch of topography near corner)

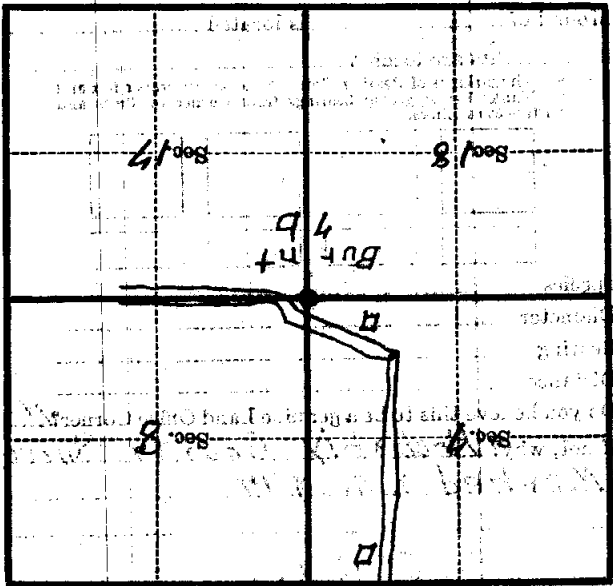

Metal Location Poster is on a **stump**

tree 12 inches diameter, on the **North**

side of **County road**

from which this corner bears **South**

131 chains distant.

Give any further facts which will aid in finding this

Corner again.

East-West road turns N.W.

14 ch. East of corner

COMMISSIONER OF PUBLIC SURVEY

MISSOURI NATIONAL FOREST

U. S. Department of Agriculture

8-7304

T 142 R 26 S 74 MET.