

Form 874-B—Revised May, 1918  
U. S. Department of Agriculture  
FOREST SERVICE

J-9, 10  
JHE

CHIPPEWA NATIONAL FOREST

CORNERS OF THE PUBLIC SURVEY

T. 142 R. 25 5 Mer.  
M.C.

Corner common to Sections  
9 and 16

Corner consists of a post (not) in place  
State condition fair

Dimensions above ground 20" inches  
Sketch grooves, letters, figures, or notches, on proper face or edge.

CARDINAL POSITION

DIAGONAL POSITION

--	--	--	--

N W S E

--	--	--	--

NW SW SE NE

Mound of \_\_\_\_\_ is located \_\_\_\_\_

Pits are located \_\_\_\_\_

Sketch markings of Bearing Trees (or Rocks) in proper box and fill blanks below, giving bearings from Corner to Trees and Distances in Links.

Species \_\_\_\_\_

Diameter \_\_\_\_\_

Bearing \_\_\_\_\_

Distance \_\_\_\_\_

Do you believe this to be a genuine Land Office Corner? No

If not, why? Co. Corner

*R. Heppert*

(Signature)

6-28-40  
(Date)

*J. E.*

(Title)

-88-30 (Make sketch of topography near Corner)

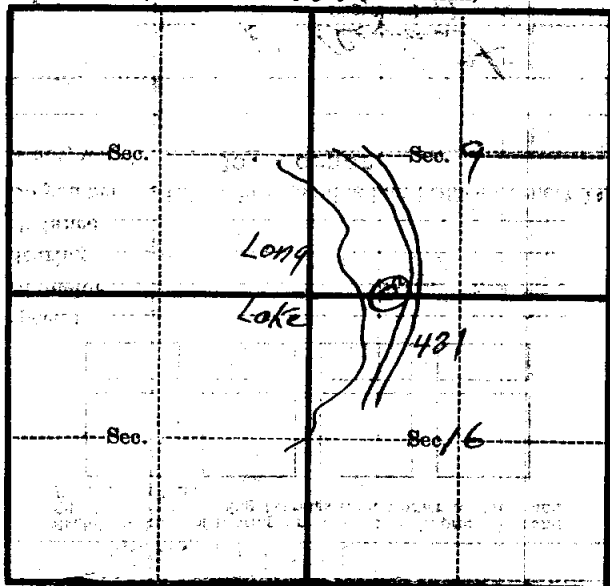

Metal Location Poster is on a Balsam poplar tree 6 inches diameter, on the East side of tree from which this Corner bears South .10 chains distant.

Give any further facts which will aid in finding this Corner again.

Balsam poplar is blazed on 3 sides.

18° 36' E 16 chs. 1951  
18° 36' E 16 chs. 1951  
18° 36' E 16 chs. 1951

J, 9, 10  
 J-10, +1

CHIPPENAW NATIONAL FOREST

**CORNERS OF THE PUBLIC SURVEY**

T. 142 R. 25 S. 5 Mer.  
N.C.

Corner common to Sections  
 \_\_\_\_\_, \_\_\_\_\_, and 16

Corner consists of a stone (not) in place  
 State condition fair

Dimensions above ground 20" inches  
 Sketch grooves, letters, figures, or notches, on proper face or edge.

CARDINAL POSITION

DIAGONAL POSITION

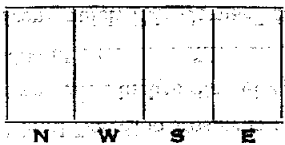

Mound of \_\_\_\_\_ is located \_\_\_\_\_

Pits are located \_\_\_\_\_

Sketch markings of Bearing Trees (or Rocks) in proper box and fill blanks below, giving bearings from Corner to Trees and Distances in Links.

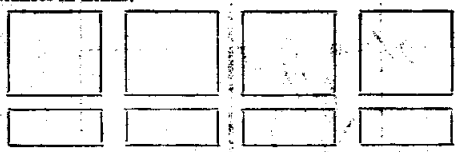

Species \_\_\_\_\_

Diameter \_\_\_\_\_

Bearing \_\_\_\_\_

Distance \_\_\_\_\_

Do you believe this to be a genuine Land Office Corner? No

If not, why? Do. Corner

R. De Sant  
 (Signature)

6-22-10

(Date)

D. E.  
 (Title)

(Make sketch of topography near Corner)

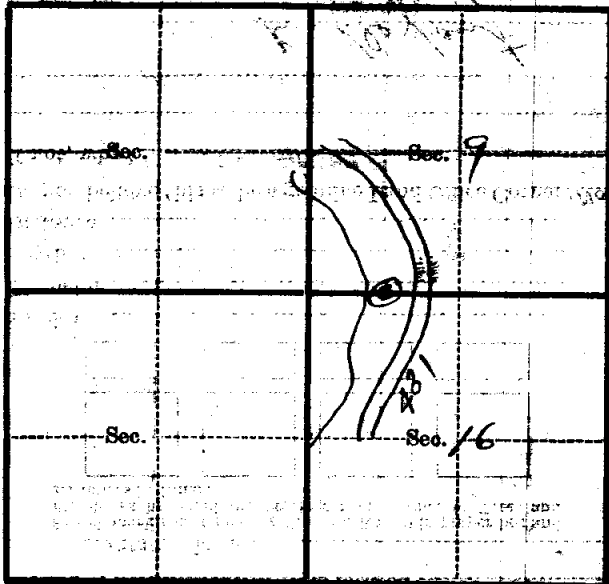

Metal Location Poster is on a Balsam tree  
 tree 4 inches diameter, on the East  
 side of tree  
 from which this Corner bears South  
230 chains distant.

Give any further facts which will aid in finding this Corner again:

Balsam tree is blazed on  
3 sides.



Form 677-9—Revised May, 1933

U. S. Department of Agriculture

FOREST SERVICE

① J-9, 10  
J-10, H

CHILDERS NATIONAL FOREST

CORNERS OF THE PUBLIC SURVEY

T. 142 R. 25 5 Mer.  
N.C.

Corner common to Sections  
9, and 16

Corner consists of a rock (not) in place  
State condition fair

Dimensions above ground 500 inches

Sketch grooves, letters, figures, or notches, on proper face

CARDINAL POSITION

DIAGONAL POSITION

--	--	--	--

N W S E

--	--	--	--

NW SW SE NE

Mound of \_\_\_\_\_ is located \_\_\_\_\_

Pits are located \_\_\_\_\_

Sketch markings of Bearing Trees (or Rocks) in proper box and fill blanks below, giving bearings from Corner to Trees and Distances in Links.

Species \_\_\_\_\_

Diameter \_\_\_\_\_

Bearing \_\_\_\_\_

Distance \_\_\_\_\_

Do you believe this to be a genuine Land Office Corner? No

If not, why? No. corner

R. Defaut  
(signature)

6-2-33

26

(This is the \_\_\_\_\_) (This is the Corner)

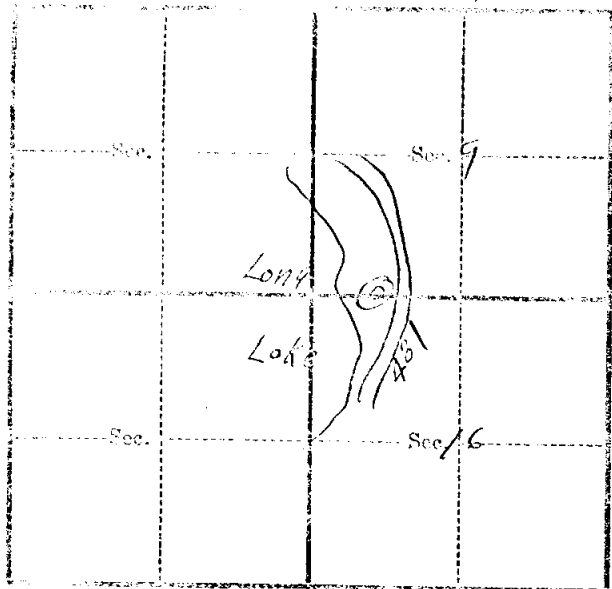

Mark Location Poster is on a balcony near  
 tree 12 inches diameter, on the west  
 side of base  
 from which this Corner bears 120°  
10 chains distant.

Give any further facts which will aid in finding this  
 Corner again.

12 chains away to blaze on  
12 side.

