

U. S. Department of Agriculture
FOREST SERVICE

Posted J-24

Chippewa NATIONAL FOREST

CORNERS OF THE PUBLIC SURVEY

T. *141* R. *31* Mer. *5*

E 1/16 Corner common to Sections

12, 13, and

Corner consists of a *Brass plate* (not) in place
State condition

Dimensions above ground *2 1/2" dia* inches

Sketch grooves, letters, figures, or notches, on proper face or edge.

CARDINAL POSITION

DIAGONAL POSITION

--	--	--	--

N W S E

--	--	--	--

NW SW SE NE

Mound of is located

Pits are located

Sketch markings of Bearing Trees (or Rocks) in proper box and fill blanks below, giving bearings from Corner to Trees and Distances in Links.

Species

Diameter

Bearing

Distance

Do you believe this to be a genuine Land Office Corner? *Yes*

If not, why?

AM R. ...
(Signature)

ENGINEER
(Title)

3/7/35
(Date)

Lined writing area with horizontal dashed lines.

Corner again.

Give any further facts which will aid in finding this

chains distant.

from which this Corner bears

side of

tree inches diameter, on the

Metal Location Poster is on a *NONE*

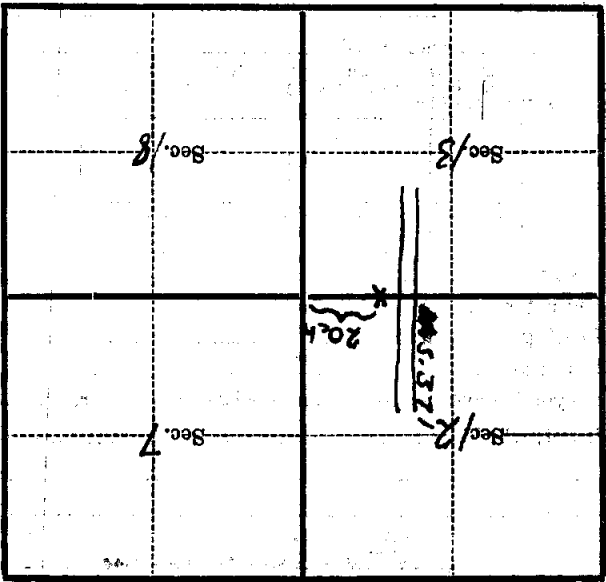

(Make sketch of topography near Corner)

Mer. 1-24

T. 141 N. R. 31 W. 5

Form 874-9—Revised May, 1918
U. S. Department of Agriculture
FOREST SERVICE

S.O.

LWB

Chippewa NATIONAL FOREST J24

CORNERS OF THE PUBLIC SURVEY

T. 141 R. 31 5 Mer.

E 1/16 Corner common to Sections

12, 13, and

Corner consists of a 1" iron pipe w/brass cap. found in place

State condition Good

Dimensions above ground 6 inches

Sketch grooves, letters, figures, or notches, on proper face or edge.

CARDINAL POSITION

DIAGONAL POSITION

--	--	--	--

--	--	--	--

N W S E

NW SW SE NE

Mound of is located

Pits are located

Sketch markings of Bearing Trees (or Rocks) in proper box and fill blanks below, giving bearings from Corner to Trees and Distances in Links.

	No	B. Ts.	

Species

Diameter

Bearing

Distance

Do you believe this to be a genuine Land Office Corner? Yes

If not, why?

H. E. ALTMAN

(Signature)

Assistant Ranger

(Title)

6/9/36

(Date)

tote road.

Highway # 371 and 1 chain south of

Corner is 2 chs. east of U. S.

Corner again.

Give any further facts which will aid in finding this

chains distant.

from which this Corner bears

side of

tree inches diameter, on the

Metal Location Poster is on a

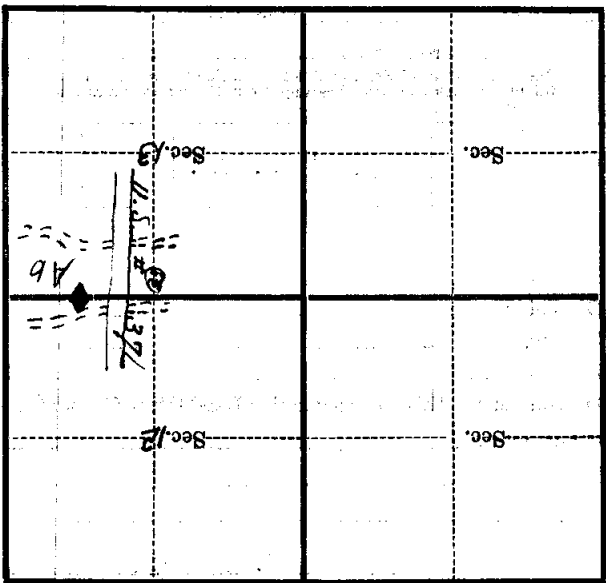

(Make sketch of topography near Corner)