

U. S. Department of Agriculture
FOREST SERVICE

OK
✓
V7

Chippewa NATIONAL FOREST

CORNERS OF THE PUBLIC SURVEY

T. *141 N.* R. *30 W.* *5th* Mer.

1/4 Corner common to Sections

29, and 32

Corner consists of a *3rd Sec. Iron post* (not) in place

State condition *Good*

Dimensions above ground *30"* inches

Sketch grooves, letters, figures, or notches, on proper face or edge.

CARDINAL POSITION

DIAGONAL POSITION

--	--	--	--

N W S E

--	--	--	--

NW SW SE NE

Mound of _____ is located _____

Pits are located _____

Sketch markings of Bearing Trees (or Rocks) in proper box and fill blanks below, giving bearings from Corner to Trees and Distances in Links.

Species *Rotten Iron Stump - Shows old survey*

Diameter *12"* *marks*

Bearing *N4W*

Distance *15*

Do you believe this to be a genuine Land Office Corner? *Yes*

If not, why? *Cannot find any other evidence, but believe it sufficient to hold.*

Carl E. Stoddard
(Signature)

Foreman - F48
(Title)

6/9/37
(Date)

Corner again.

Give any further facts which will aid in finding this

chains distant.

side of from which this Corner bears *S 46 W*

tree *5* inches diameter, on the

Metal Location Poster is on a *col*

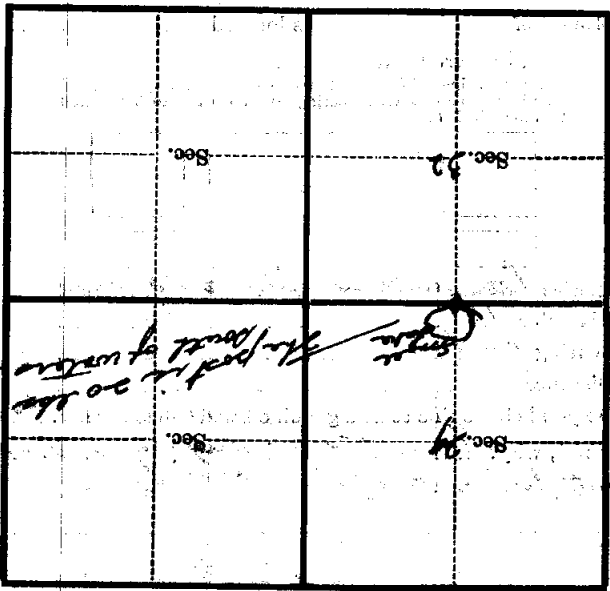

(Make sketch of topography near Corner)

T. WIN R. *3 W* 5

V-7 Mer.