

U. S. Department of Agriculture  
FOREST SERVICE

NATIONAL FOREST

CORNERS OF THE PUBLIC SURVEY

T. 141 R. 29/28 5<sup>th</sup> Mer.

1/4 Corner common to Sections  
19, and 24

Corner consists of a \_\_\_\_\_ (not) in place  
State condition \_\_\_\_\_

Dimensions above ground \_\_\_\_\_ inches

Sketch grooves, letters, figures, or notches, on proper face or edge.

CARDINAL POSITION

DIAGONAL POSITION

--	--	--	--

N W S E

--	--	--	--

NW SW SE NE

Mound of \_\_\_\_\_ is located \_\_\_\_\_

Pits are located \_\_\_\_\_

Sketch markings of Bearing Trees (or Rocks) in proper box and fill blanks below, giving bearings from Corner to Trees and Distances in Links.

<u>1/4</u> <u>24BX</u>			
<u>NW</u>			

Species Not a tree

Diameter 15"

Bearing N. 70° W

Distance 2.200/2

Do you believe this to be a genuine Land Office Corner? \_\_\_\_\_

If not, why? \_\_\_\_\_

3/27/35 O. S. Purswood  
(Date) (Signature)  
PT (Title) P-25

-----

-----

-----

-----

-----

-----

-----

-----

-----

Corner again.

Give any further facts which will aid in finding this

chains distant.

3 1/2

from which this Corner bears NW

side of old R.R. Grade

tree inches diameter, on the North

Metal Location Poster is on a I.P.

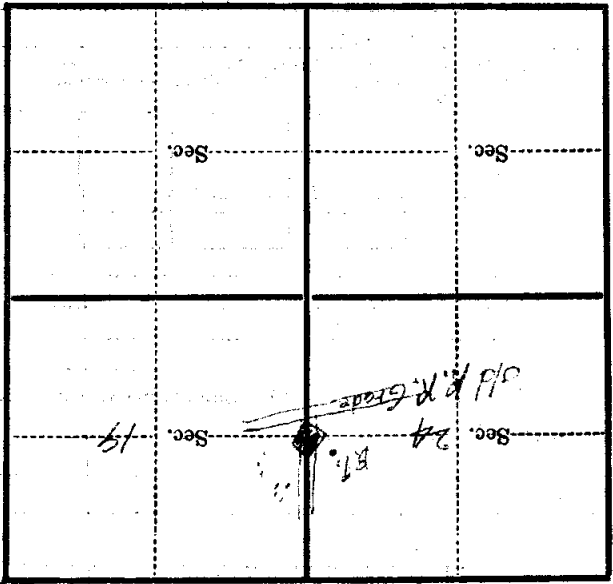

(Make sketch of topography near Corner)

P-25

Mer.

R. 29/28

T. 141