

U. S. Department of Agriculture
FOREST SERVICE

123
72937
K-22

Chippewa NATIONAL FOREST

CORNERS OF THE PUBLIC SURVEY

T. 141 N R. 29 W 5th Mer.

NW 1/4 Corner common to Sections 13, _____, and _____

Corner consists of a 1" I.M. with base cap (not) in place
State condition Good

Dimensions above ground _____ inches
Sketch grooves, letters, figures, or notches, on proper face or edge.

CARDINAL POSITION

DIAGONAL POSITION

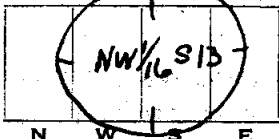

Mound of _____ is located _____

Pits are located _____

Sketch markings of Bearing Trees (or Rocks) in proper box and fill blanks below, giving bearings from Corner to Trees and Distances in Links.

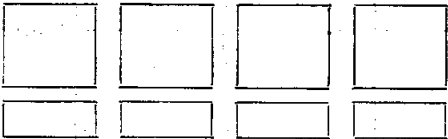

Species _____

Diameter _____

Bearing _____

Distance _____

Do you believe this to be a genuine Land Office Corner? Yes

If not, why? _____

July 1936 (Date)

Out Steadland
(Signature)
Const. For.
(Title)

K-22

Corner again.

Give any further facts which will aid in finding this

chains distant.

side of from which this Corner bears 0.67
0.889W

tree 5 inches diameter, on the

Metal Location Poster is on a *Spur*

	Sec.		Sec.
	Sec.		Sec.

(Make sketch of topography near Corner)

Mer. R-22

T 141 R 29