

U. S. Department of Agriculture
FOREST SERVICE

Chippewa

Posted J-17

NATIONAL FOREST

CORNERS OF THE PUBLIC SURVEY

T. *141* R. *29* *5* Mer.

14 Sec. Corner common to Sections

10, *16*, *14*, and *15*

Corner consists of a *G.L.O. Brass Cap* (set) in place

State condition *Good*

Dimensions above ground *6"* inches

Sketch grooves, letters, figures, or notches, on proper face or edge.

CARDINAL POSITION

DIAGONAL POSITION

N	W	S	E

<i>10</i>	<i>15</i>	<i>14</i>	<i>11</i>
NW	SW	SE	NE

Mound of _____ is located _____

Pits are located _____

Sketch markings of Bearing Trees (or Rocks) in proper box and fill blanks below, giving bearings from Corner to Trees and Distances in Links.

		<i>Sec. 14</i>	
		<i>141</i>	
		<i>29</i>	

Species _____ *N.P. Stump*

Diameter _____ *14 1/2"*

Bearing _____ *S. 10° E*

Distance _____ *32 LKS*

Do you believe this to be a genuine Land Office Corner? *Yes*

If not, why? _____

P. S. M. Eason

(Signature)

4-10-35

(Date)

E. A. ...

(Title)

J-17

Corner again.
located in center of farm
road entry, fence E & W from

Give any further facts which will aid in finding this
chains distant.
from which this Corner bears
N 10° W.
side of
tree 14 inches diameter, on the S.E.
Metal Location Poster is on a
N.P. Stump

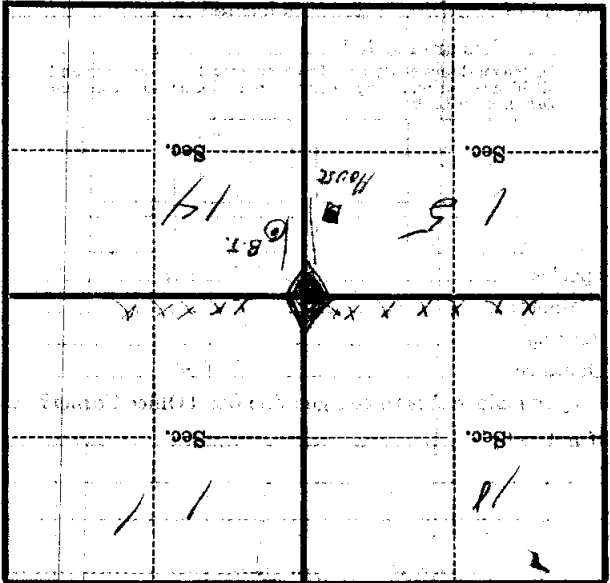

(Make sketch of topography near Corner)

T. 17 N. R. 29 E. Mer. 5-17