

Form 874-9—Revised May, 1918  
U. S. Department of Agriculture  
FOREST SERVICE

172  
7-29-37  
R-15  
HEA

Chippewa NATIONAL FOREST

CORNERS OF THE PUBLIC SURVEY

T. 141 N R. 29 W 5<sup>th</sup> Mer.

44 Corner common to Sections

22, and 27

Corner consists of a 1 1/2" Brass Cap (not) in place

State condition Good

Dimensions above ground 6" inches

Sketch grooves, letters, figures, or notches, on proper face or edge.

CARDINAL POSITION

DIAGONAL POSITION

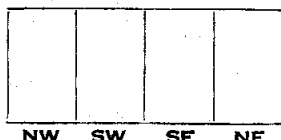
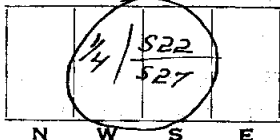

Mound of \_\_\_\_\_ is located \_\_\_\_\_

Pits are located \_\_\_\_\_

Sketch markings of Bearing Trees (or Rocks) in proper box and fill blanks below, giving bearings from Corner to Trees and Distances in Links.

Species \_\_\_\_\_

Diameter \_\_\_\_\_

Bearing \_\_\_\_\_

Distance \_\_\_\_\_

Do you believe this to be a genuine Land Office Corner? yes

If not, why? \_\_\_\_\_

Carl Steadland

(Signature)

July 1936

(Date)

Const. For

(Title)

Corner again.

Give any further facts which will aid in finding this

chains distant.

from which this Corner bears

*55 1/2 E*

side of

tree 4" inches diameter, on the

Metal Location Poster is on a *Aspen Post*

	Sec.		Sec.
	Sec.		Sec.

(Make sketch of topography near Corner)

T 141

R

29

Mer.

R-15