

U. S. Department of Agriculture

FOREST SERVICE

120  
7-29-37  
[Signature]

*Chippewa*

NATIONAL FOREST

CORNERS OF THE PUBLIC SURVEY

T. *141 N* R. *29 W* *5<sup>th</sup>* Mer.

*25 1/16* Corner common to Sections *16*, \_\_\_\_\_, and \_\_\_\_\_

Corner consists of a *1/2" M. with brass cap* (not) in place

State condition *Good*

Dimensions above ground \_\_\_\_\_ inches

Sketch grooves, letters, figures, or notches, on proper face of edge.

CARDINAL POSITION

DIAGONAL POSITION

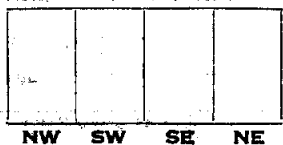
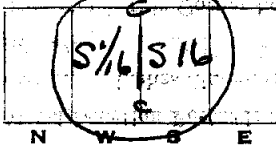

Mound of \_\_\_\_\_ is located \_\_\_\_\_

Pits are located \_\_\_\_\_

Sketch markings of Bearing Trees (or Rocks) in proper box and fill blanks below, giving bearings from Corner to Trees and Distances in Links.



Species \_\_\_\_\_

Diameter \_\_\_\_\_

Bearing \_\_\_\_\_

Distance \_\_\_\_\_

Do you believe this to be a genuine Land Office Corner? *Yes*

If not, why? \_\_\_\_\_

*Carl Steadland*  
(Signature)

*Const. Fore*  
(Title)

*July 24 1936*  
(Date)

*M-11*

Corner again.

Give any further facts which will aid in finding this

chain's distant.

from which this Corner bears

side of

tree inches diameter, on the

Metal Location Poster is on a *Support*

	Sec.		Sec.
	Sec.		Sec.

(Make sketch of topography near Corner)

*M-11*

Mer.

T 141 R 29