

U. S. Department of Agriculture
FOREST SERVICE

123
7-29-37
[Signature]

Chippewa

NATIONAL FOREST

N-11
[Signature]

CORNERS OF THE PUBLIC SURVEY

T. *141 N.* R. *29 W.* *5th* Mer.

1/4 Corner common to Sections

16, and 21

Corner consists of a *1" I.M. with brass cap* (not) in place

State condition *Good*

Dimensions above ground _____ inches

Sketch grooves, letters, figures, or notches, on proper face or edge.

CARDINAL POSITION

DIAGONAL POSITION

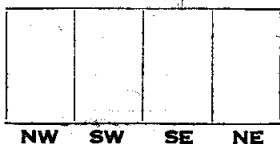
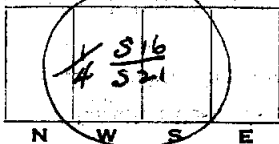

Mound of _____ is located _____

Pits are located _____

Sketch markings of Bearing Trees (or Rocks) in proper box and fill blanks below, giving bearings from Corner to Trees and Distances in Links.

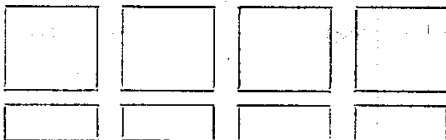

Species _____

Diameter _____

Bearing _____

Distance _____

Do you believe this to be a genuine Land Office Corner? *Yes*

If not, why? _____

Carl Steadland

(Signature)

Const. Surv.

(Title)

July 26, 1936

(Date)

N-11

Corner again.

Give any further facts which will aid in finding this

chain distant.

from which this Corner bears *0.27*
S 18 30 E

side of

tree *5* inches diameter, on the

Metal Location Poster is on a

Copied

	Sec.		Sec.
	Sec.		Sec.

(Make sketch of topography near Corner)

N-11

Mer.

T. 141 R. 29