

Form 874-B—Revised May, 1918  
 U. S. Department of Agriculture  
 FOREST SERVICE

*Posted N-1*

*Chippewa* NATIONAL FOREST

CORNERS OF THE PUBLIC SURVEY

T. *141N* R. *30W-29W* S. *5* Mer.

Sec *13*, *18*, *24*, and *19*  
 Corner common to Sections

Corner consists of a *Pipe 1' ht.* (note) in place  
 State condition

Dimensions above ground *12" ht 2 1/2" dia* inches  
 Sketch grooves, letters, figures, or notches, on proper face or edge.

CARDINAL POSITION

DIAGONAL POSITION

--	--	--	--

N W S E

--	--	--	--

NW SW SE NE

Mound of \_\_\_\_\_ is located \_\_\_\_\_

Pits are located \_\_\_\_\_

Sketch markings of Bearing Trees (or Rocks) in proper box and fill blanks below, giving bearings from Corner to Trees and Distances in Links.

<i>T R 1 30W</i>			
<i>B. T.</i>			

Species *Ash*  
 Diameter *9"*  
 Bearing *N 3° E*  
 Distance *30'*

Do you believe this to be a genuine Land Office Corner? *Yes*

If not, why? \_\_\_\_\_

*W. J. ...*  
 (Signature)

ENGINEER

(Title)

*3/18/35*  
 (Date)

*N-1*

Corner again.

Give any further facts which will aid in finding this  
shams distant.  
from which this Corner bears  
side of  
tree inches diameter, on the  
Metal Location Poster is on a

NONE

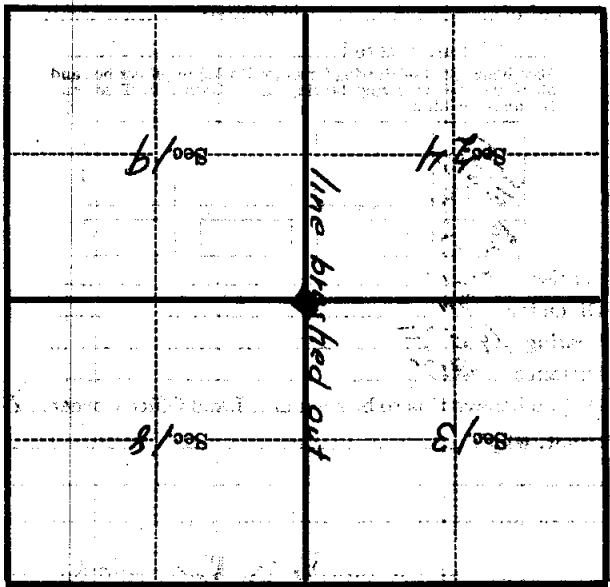

(Make sketch of topography near Corner)

T/AIN R.30W-29W 5 Mer. N-1