

U. S. Department of Agriculture

FOREST SERVICE

2 21

Chippewa NATIONAL FOREST

CORNERS OF THE PUBLIC SURVEY

T. 141 N R. 28 W 5th Mer.

Section _____ Corner common to Sections

35, and 36

Corner consists of a 6" cedar post (~~root~~) in place

State condition good

Dimensions above ground 36 inches

Sketch grooves, letters, figures, or notches, on proper face or edge.

CARDINAL POSITION

DIAGONAL POSITION

--	--	--	--

N W S E

--	--	--	--

NW SW SE NE

Mound of _____ is located _____

Pits are located _____

Sketch markings of Bearing Trees (or Rocks) in proper box and fill blanks below, giving bearings from Corner to Trees and Distances in Links.

S36- 141- 28	S35- 141- 28		
B.T.	B.T.		

Species Cedar Cedar _____

Diameter 7" 9" _____

Bearing N59°E N24¹/₂°W _____

Distance 15 lks. 24 lks. _____

Do you believe this to be a genuine Land Office Corner? no

If not, why? County records show that it

was set by County Surveyor in 1912.

Arthur T. Johnson
Arthur T. Johnson

(Signature)

Semi-skilled Worker

(Title)

4/5/38

(Date)

Z-21

llh

skidding trail.

Corner lies just east of old

Corner again.

Give any further facts which will aid in finding this

chain distant.

from which this Corner bears

side of

tree inches diameter, on the

Metal Location Poster is on a

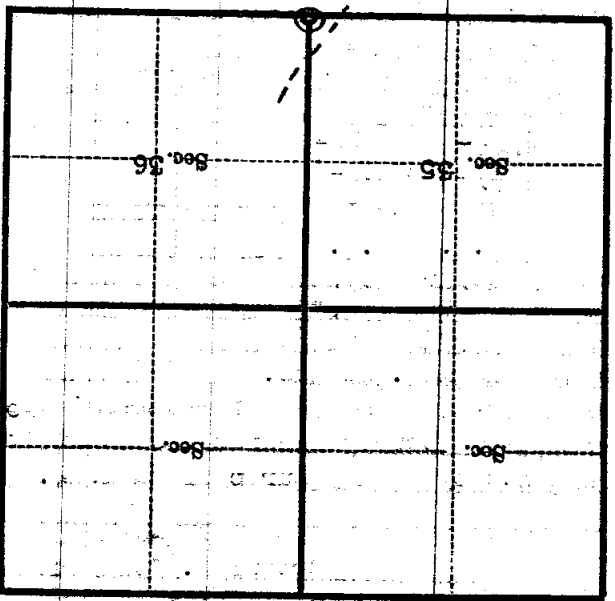

(Make sketch of topography near Corner)

Mer.

5th

R. 28 W.

T. 141 N.

2-0