

U. S. Department of Agriculture

FOREST SERVICE

NATIONAL FOREST

CORNERS OF THE PUBLIC SURVEY

T. 141 R. 28 5th Mer.E. 116 Corner common to Sections4, 5, 9, and

Corner consists of a _____ (not) in place

State condition _____

Dimensions above ground _____ inches

Sketch grooves, letters, figures, or notches, on proper face or edge.

CARDINAL POSITION

DIAGONAL POSITION

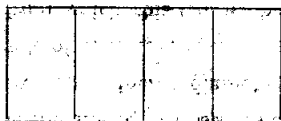

N W S E

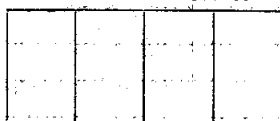

NW SW SE NE

Mound of _____ is located _____

Pits are located _____

Sketch markings of Bearing Trees (or Rocks) in proper box and fill blanks below, giving bearings from Corner to Trees and Distances in Links.

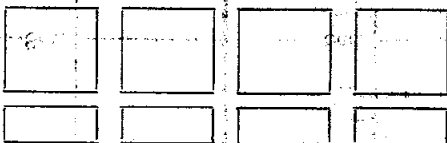
Species J. PineDiameter 12 dbhBearing N.E.Distance 50 linksDo you believe this to be a genuine Land Office Corner? Yes

If not, why? _____

Norman B. Shaw
 (Signature)

Mar 5, 35 Engineer
 (Date) (Title)

E-12 8-7394

Corner again.
North side of road.
N. of farm on S. side road

Give any further facts which will aid in finding this
chain distant.

from which this Corner bears 5. W.
side of tree
tree 10 inches diameter, on the South
Metal Location Poster is on a black pine

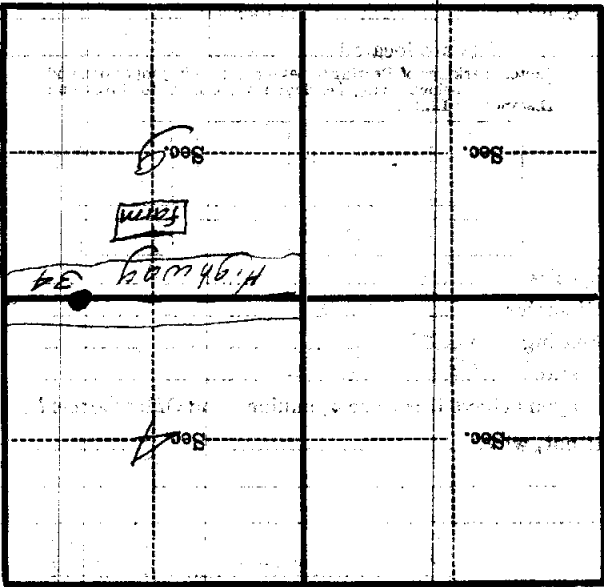

(Make sketch of topography near Corner)