

U. S. Department of Agriculture

FOREST SERVICE

V10

Chippewa NATIONAL FOREST

CORNERS OF THE PUBLIC SURVEY

T. 141 N R. 28 W 5th Mer.

~~W~~ 1/16 # 2 33 Corner common to Sections  
28, and 33

Corner consists of a 2" iron pipe ~~mark~~ in place

State condition good

Dimensions above ground 8 inches

Sketch grooves, letters, figures, or notches, on proper face or edge.

CARDINAL POSITION

DIAGONAL POSITION

--	--	--	--

N W S E

--	--	--	--

NW SW SE NE

Mound of \_\_\_\_\_ is located \_\_\_\_\_

Pits are located \_\_\_\_\_

Sketch markings of Bearing Trees (or Rocks) in proper box and fill blanks below, giving bearings from Corner to Trees and Distances in Links.

Grown over			

Species R. Oak

Diameter 6"

Bearing S11°E

Distance 66

Do you believe this to be a genuine Land Office Corner? no

If not, why? No brass cap and pipe of the type set by County Engineer.

*Arthur W. Johnson*  
 Arthur W. Johnson  
 (Signature)

8/29/38  
 (Date)

State Project Ass't  
 (Title)

V-10

*[Handwritten initials]*

-----

-----

-----

-----

-----

-----

-----

-----

-----

-----

Hackensack-Longville road.

Corner set in south ditch of

Corner again.

Give any further facts which will aid in finding this

chains distant.

from which this Corner bears

S110W

side of Hackensack-Longville road

tree 6 inches diameter, on the south

Metal Location Poster is on a Red Oak

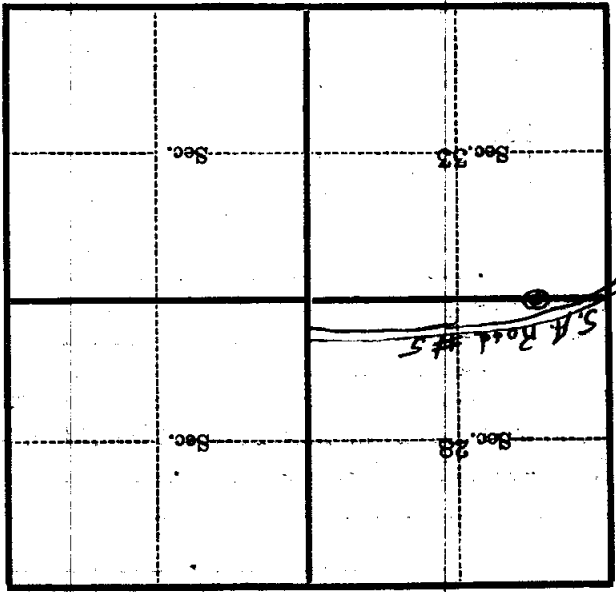

(Make sketch of topography near Corner)

T. 141 N

R. 28 W

5th Mer.

V-10