

U. S. Department of Agriculture

FOREST SERVICE

Plotted A-9

Chippewa NATIONAL FOREST

CORNERS OF THE PUBLIC SURVEY

T/AIN-142NR. 28W Mer.

Sec. Corner common to Sections
32, 33, 4, and 5

Corner consists of a _____ (not) in place
State condition _____

Dimensions above ground _____ inches

Sketch grooves, letters, figures, or notches, on proper face or edge.

CARDINAL POSITION

DIAGONAL POSITION

--	--	--	--

--	--	--	--

N W S E

NW SW SE NE

Mound of _____ is located _____

Pits are located _____

Sketch markings of Bearing Trees (or Rocks) in proper box and fill blanks below, giving bearings from Corner to Trees and Distances in Links.

<i>T</i> <i>18"</i> <i>S(?)W</i>			
<i>Q.T.</i>			

Species *N. Pine*

Diameter *18"*

Bearing *S(?)W*

Distance *1cb*

Do you believe this to be a genuine Land Office Corner? *Yes*

If not, why? _____

H.W.K. [Signature]

(Signature)

ENGINEER

(Title)

3/13/36

(Date)

A-9

Metal Location Poster is on a *NONE*
 tree _____ inches diameter, on the
 side of _____
 from which this Corner bears _____
 chains distant.
 Give any further facts which will aid in finding this
 Corner again.

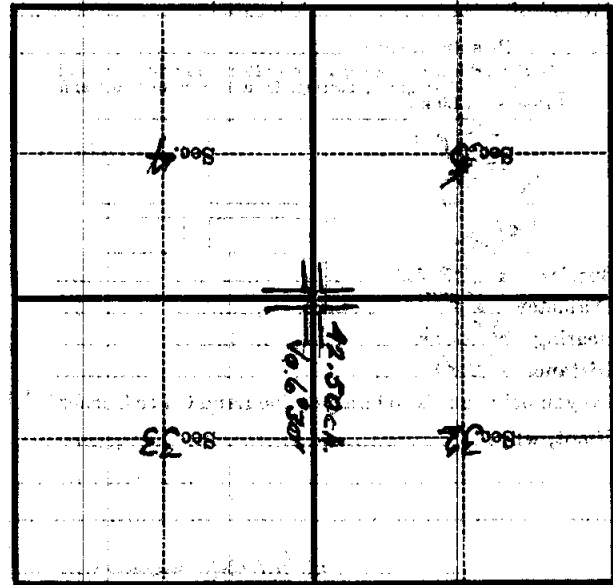

(Make sketch of topography near Corner)

T. J. HAIN-FANN R. 28W
 5th Mer. A-9