

U. S. Department of Agriculture
FOREST SERVICE

Chippewa NATIONAL FOREST

CORNERS OF THE PUBLIC SURVEY

T. 141N R. 28W 5th Mer.

1/4 Corner common to Sections

17, and 16

Corner consists of a Brass plate (not) in place

State condition

Dimensions above ground 2 1/2" dia. inches

Sketch grooves, letters, figures, or notches, on proper face or edge.

CARDINAL POSITION

DIAGONAL POSITION

--	--	--	--

N W S E

--	--	--	--

NW SW SE NE

Mound of _____ is located _____

Pits are located _____

Sketch markings of Bearing Trees (or Rocks) in proper box and fill blanks below, giving bearings from Corner to Trees and Distances in Links.

<u>1/4</u> <u>5</u> <u>17</u>

--

--

--

<u>B.T</u>

--

--

--

Species L Pine

Diameter 9"

Bearing NCW

Distance 5ch

Do you believe this to be a genuine Land Office Corner? Yes

If not, why? _____

Wm. J. ...

(Signature)

ENGINEER

(Title)

3/26/35

(Date)

L-9

Corner again.

Give any further facts which will aid in finding this

chains distant.

from which this Corner bears

side of

tree inches diameter, on the

Metal Location Poster is on a **NONE**

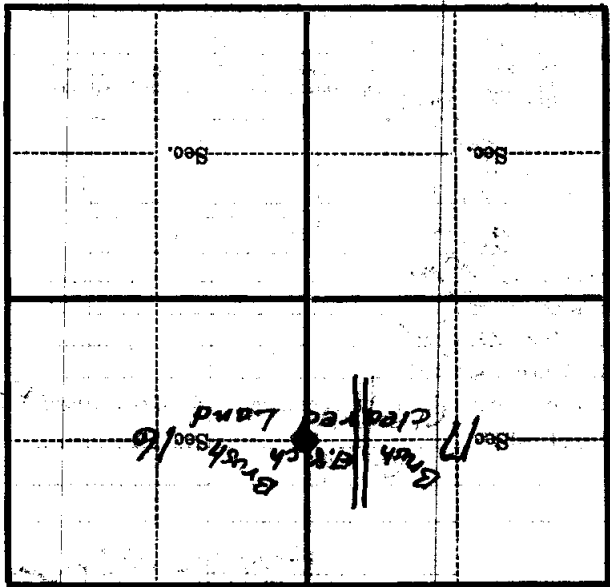

(Make sketch of topography near Corner)

T. 191N R. 28W

574

Mer.