

U. S. Department of Agriculture  
FOREST SERVICE

V-9

Chippewa NATIONAL FOREST

CORNERS OF THE PUBLIC SURVEY

T. 141 N R. 28 W 5th Mer.

Section

Corner common to Sections

28

29

~~30~~  
33

and ~~32~~

Corner consists of a \_\_\_\_\_ (not) in place

State condition \_\_\_\_\_

Dimensions above ground \_\_\_\_\_ inches

Sketch grooves, letters, figures, or notches, on proper face or edge.

CARDINAL POSITION

DIAGONAL POSITION

--	--	--	--

N W S E

--	--	--	--

NW SW SE NE

Mound of \_\_\_\_\_ is located \_\_\_\_\_

Pits are located \_\_\_\_\_

Sketch markings of Bearing Trees (or Rocks) in proper box and fill blanks below, giving bearings from Corner to Trees and Distances in Links.

T141N
R28 W

T141N
R28W



B.T.
------

B.T.
------

--

--

Species N.Pine N.Pine

Diameter 8" 10"

Bearing N30°E N65°W

Distance 92 lks. 102 lks.

Do you believe this to be a genuine Land Office Corner? YES

If not, why? \_\_\_\_\_

*Arthur P. Johnson*  
Arthur P. Johnson

(Signature)

Project Ass't

(Title)

8/26/38

(Date)

V-9

*APJ*

-----

-----

-----

-----

-----

-----

-----

-----

-----

-----

Corner again.

Give any further facts which will aid in finding this

chains distant.

0.50

from which this Corner bears N10E side of Hackensack & Longville road

~~100~~ inches diameter, on the south

Metal Location Poster is on a Survey marker

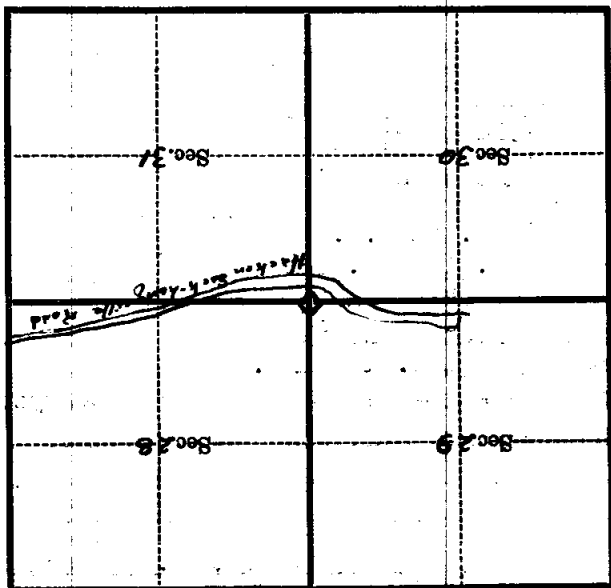

(Make sketch of topography near Corner)

T. 141 N. R. 28 W. 5th Mer. 1-9