

U. S. Department of Agriculture
FOREST SERVICE

NATIONAL FOREST

CORNERS OF THE PUBLIC SURVEY

T. 1A1 R. 28 5th Mer.

Section 17 Corner common to Sections
17, 18, 19, and 20

Corner consists of a Pipe and Cap (not) in place
State condition Good

Dimensions above ground 12 inches

Sketch grooves, letters, figures, or notches, on proper face or edge.

CARDINAL POSITION

DIAGONAL POSITION

--	--	--	--

N W S E

--	--	--	--

NW SW SE NE

Mound of _____ is located _____

Pits are located _____

Sketch markings of Bearing Trees (or Rocks) in proper box and fill blanks below, giving bearings from Corner to Trees and Distances in Links.

Species _____

Diameter _____

Bearing _____

Distance _____

Do you believe this to be a genuine Land Office Corner? Yes

If not, why? _____

3/19/35 O. Y. Juarez
(Date) (Signature)
N-5 Eng
8-7394 (Title)

Corner again.
 2nd Metal Location Post
 also placed on fence
 post on corner.
 fence is of Rail Type
 and barb wire.
 2" Iron Pipe. County
 Survey also at corner.
 18" high.

Metal Location Poster is on a **Oak**
 tree 8 inches diameter, on the **North**
 side of **Road**
 from which this Corner bears
 19.3°
 chains distant.
 Give any further facts which will aid in finding this

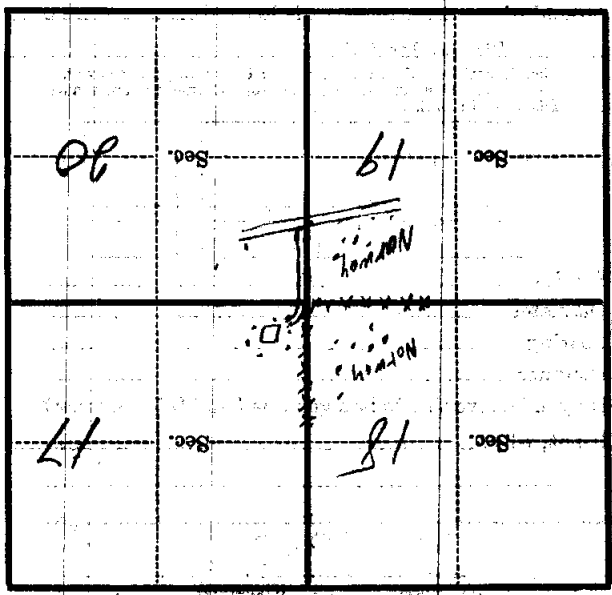

(Make sketch of topography near Corner)

N-5 Mer.

R.

T.